

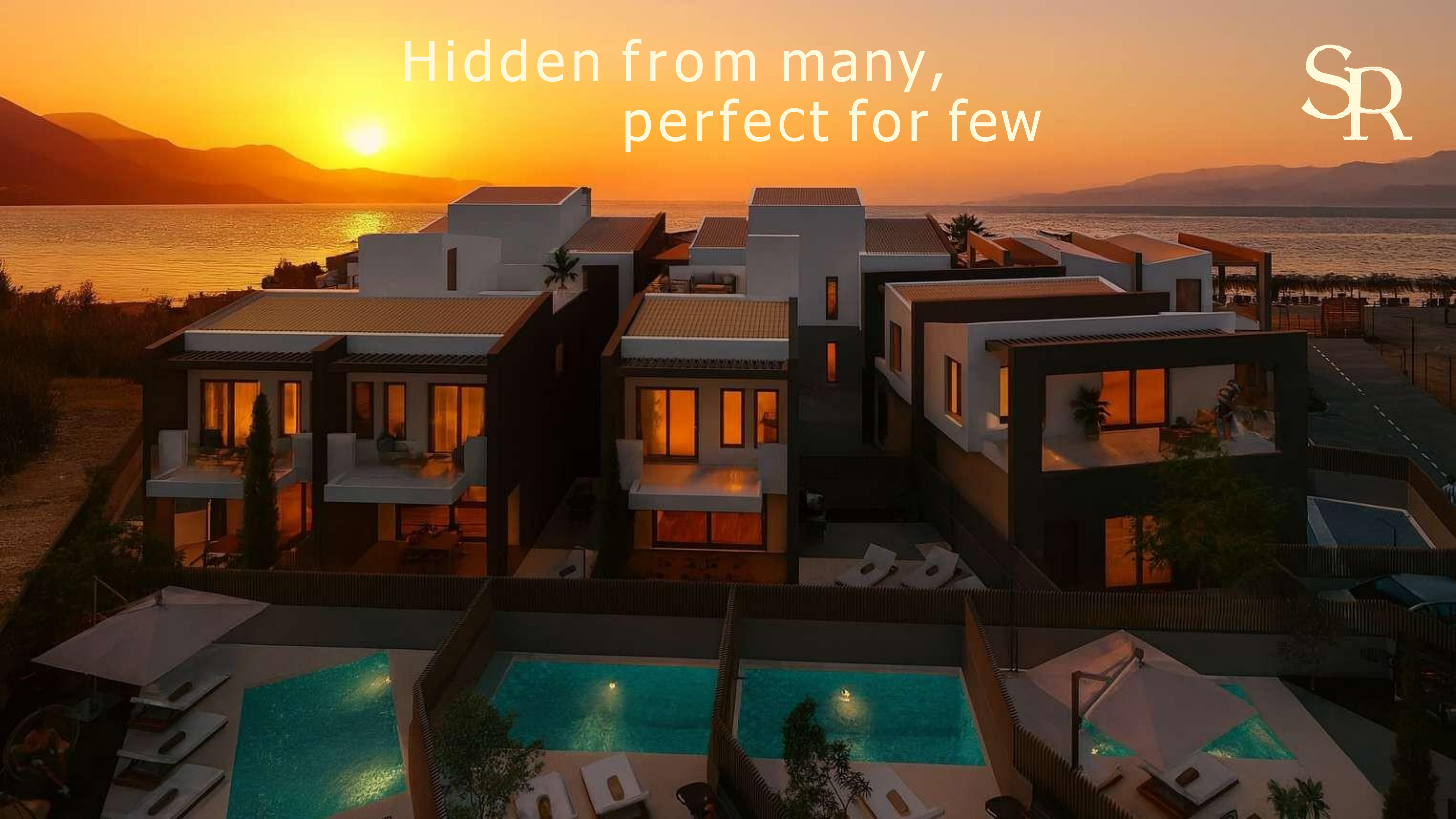

The Sea'cret  
Residences  
*Chiliadou*

Hidden from many,  
perfect for few

SR



# THE CONCEPT

In a world of crowded destinations and standard offerings, we create something different.

***Sea'cret Residences Chiliadou*** —  
modern coastal living in Greece's  
hidden gem, just 30 min from Patras.  
10 min. from Nafpaktos.  
20 min. from Trizonia Island.  
20 min. from the Rio bridge.  
1hour from Galaxidiä.  
2 hours from Lefkada.

***A secret worth discovering***



The Sea'cret  
Residences  
*Chiliadou*

# THE LOCATION

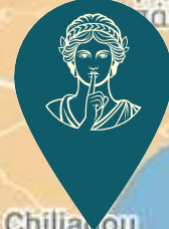

***Chiliadou, Dorida, Fokida***  
Central Greece, Corinthian Gulf  
A cosy village.  
Blue Flag beach.  
No crowds.  
Pure authenticity.  
***Your secret escape  
within reach of civilization.***

# STRATEGIC CONNECTIVITY: *Aktion / Preveza Airport (PVK)*



**38 International destinations**  
in 14 countries.



**4 Domestic routes** connecting  
mainland & islands.



**OPERATIONAL PEAK:**  
Premier "Summer Hub"  
(April/May - October/November).

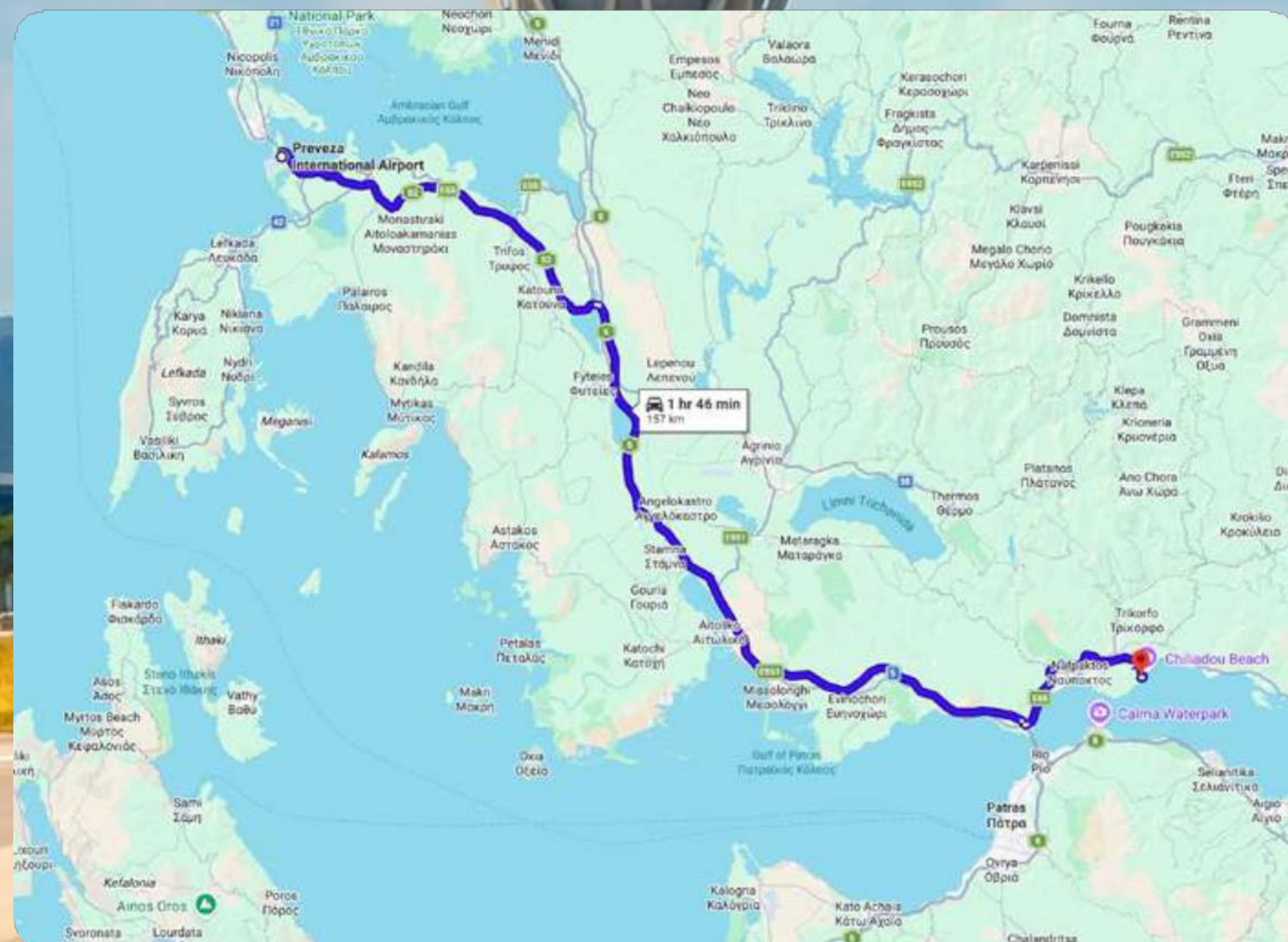

## **UNITED KINGDOM (10):**

Birmingham, Bristol, Edinburgh, London (Gatwick, Heathrow, Luton, Stansted), Manchester, Newcastle, Nottingham.

## **ITALY (7):**

Bari, Bologna, Bolzano, Milan (Bergamo, Malpensa), Naples, Rome (Fiumicino).



## **GERMANY (6):**

Berlin, Düsseldorf, Frankfurt, Munich, Nuremberg, Stuttgart.



## **REST OF EUROPE:**

 **Austria:** Vienna |  **Czech Republic:** Prague |

 **Denmark:** Copenhagen

 **France:** Paris (Orly) |  **Hungary:** Budapest |

 **Netherlands:** Amsterdam

 **Norway:** Oslo |  **Poland:** Radom |

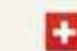
 **Switzerland:** Zurich

## **MIDDLE EAST:**

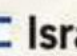
 **Israel:** Tel Aviv (Seasonal) |  **Cyprus:** Larnaca

# STRATEGIC CONNECTIVITY: **PATRAS – ARAXOS AIRPORT (GPA)**

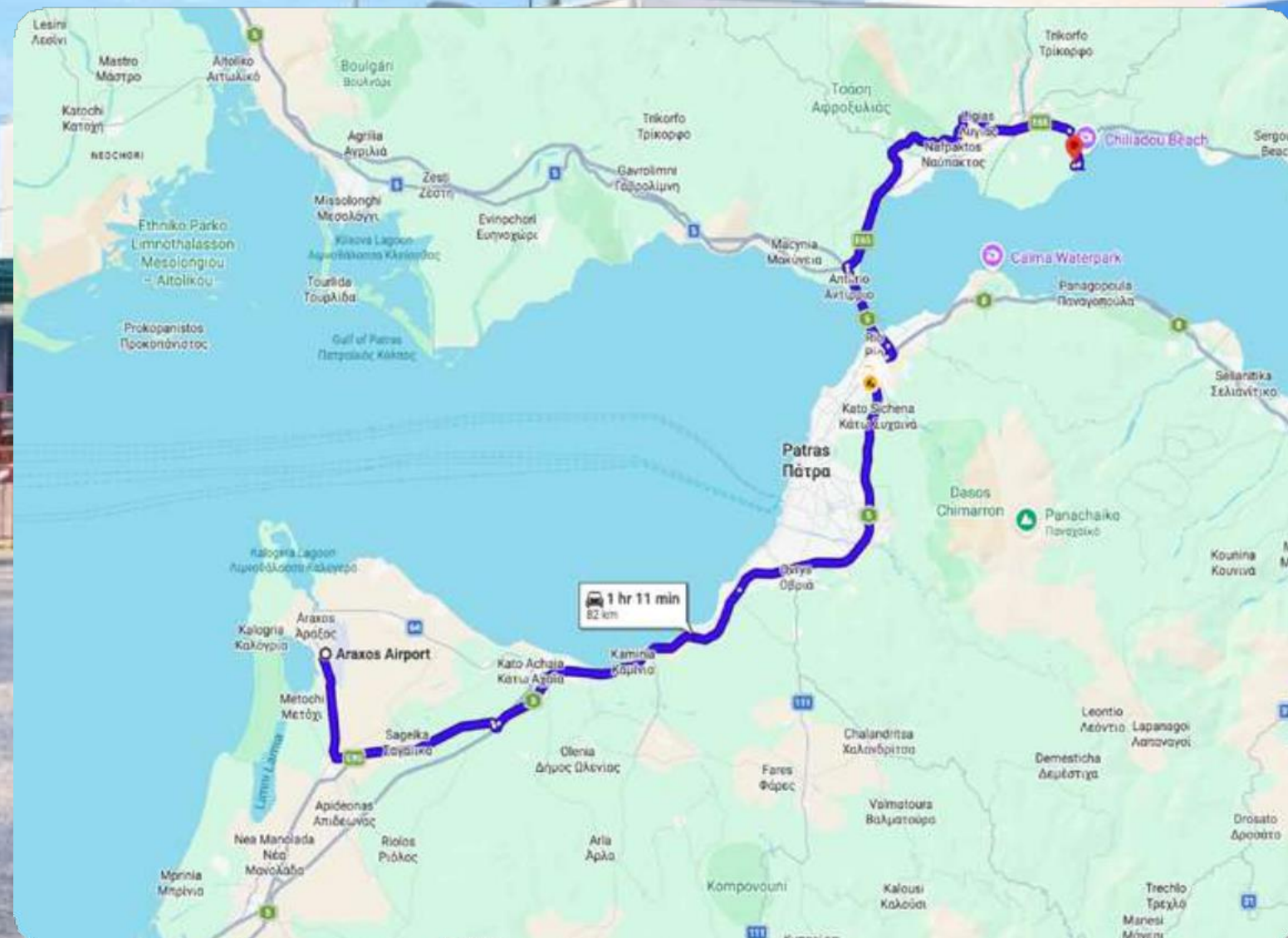

**17 International destinations** in 9 countries.



**2 Domestic routes** connecting mainland & islands (Corfu, Zakynthos).



**OPERATIONAL PEAK:**  
Premier "Summer Hub"  
(May – September/October).

## **GERMANY (5):**

Düsseldorf, Frankfurt, Hanover, Munich, Stuttgart.

## **FRANCE (3):**

Lille, Nantes, Paris (Orly).

## **REST OF EUROPE:**

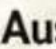
 **Austria:** Vienna |  **Czech Republic:** Prague |

 **Italy:** Milan (Malpensa)

 **Luxembourg:** Luxembourg City |

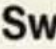
 **Switzerland:** Zürich |  **Albania:** Vlorë

## **UPCOMING & RENEWALS:**

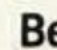
 **Belgium:** Brussels (Launching Sept 2028) |

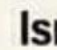
 **Israel:** Tel Aviv (Seasonal renewal expected)

# STRATEGIC CONNECTIVITY: **ATHENS INTERNATIONAL AIRPORT (ATH)**

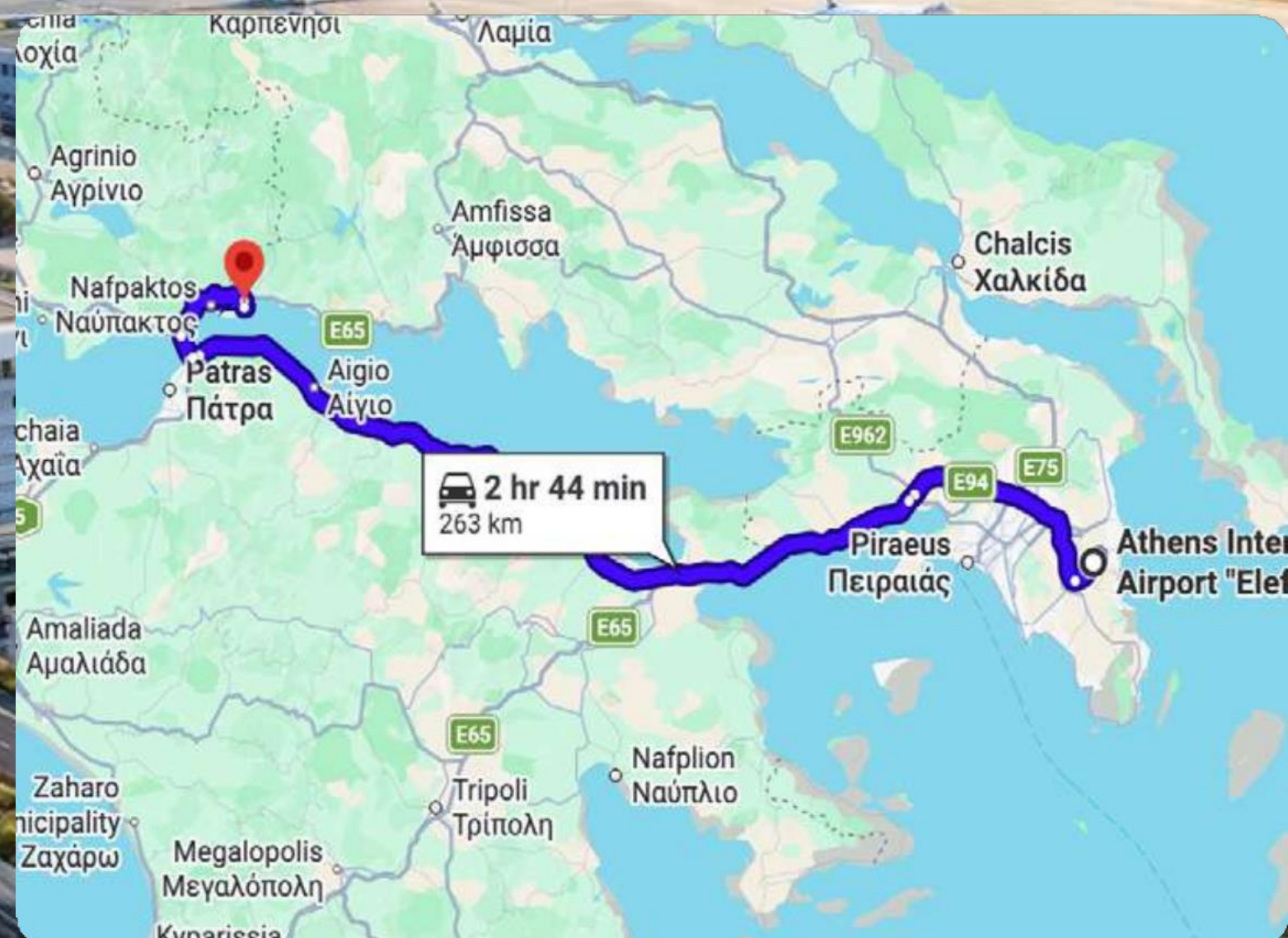

**Global Hub:** Handling over 34 million passengers with direct connections to more than 160 airports worldwide.



**Year-Round Access:** Unlike regional seasonal airports, ATH operates at full capacity 365 days a year, ensuring constant accessibility.



**Rapid Growth:** An 8.6% increase in international traffic highlights Greece's booming status as a premier global destination.

## **NORTH AMERICA (9+):**

New York, Chicago, Dallas (launching May 2026), Atlanta, Boston, Philadelphia, Montreal, Toronto.

## **ASIA & MIDDLE EAST:**

Beijing, Shanghai, Delhi & Mumbai (new for 2026), Dubai, Abu Dhabi, Tel Aviv.

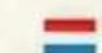

## **EUROPE & UK:**

Direct links to 10+ UK cities and every major European capital (Italy, Germany, France, etc.).

**Belgium:** Brussels (Launching)  
**Israel:** Tel Aviv (Seasonal renewal)

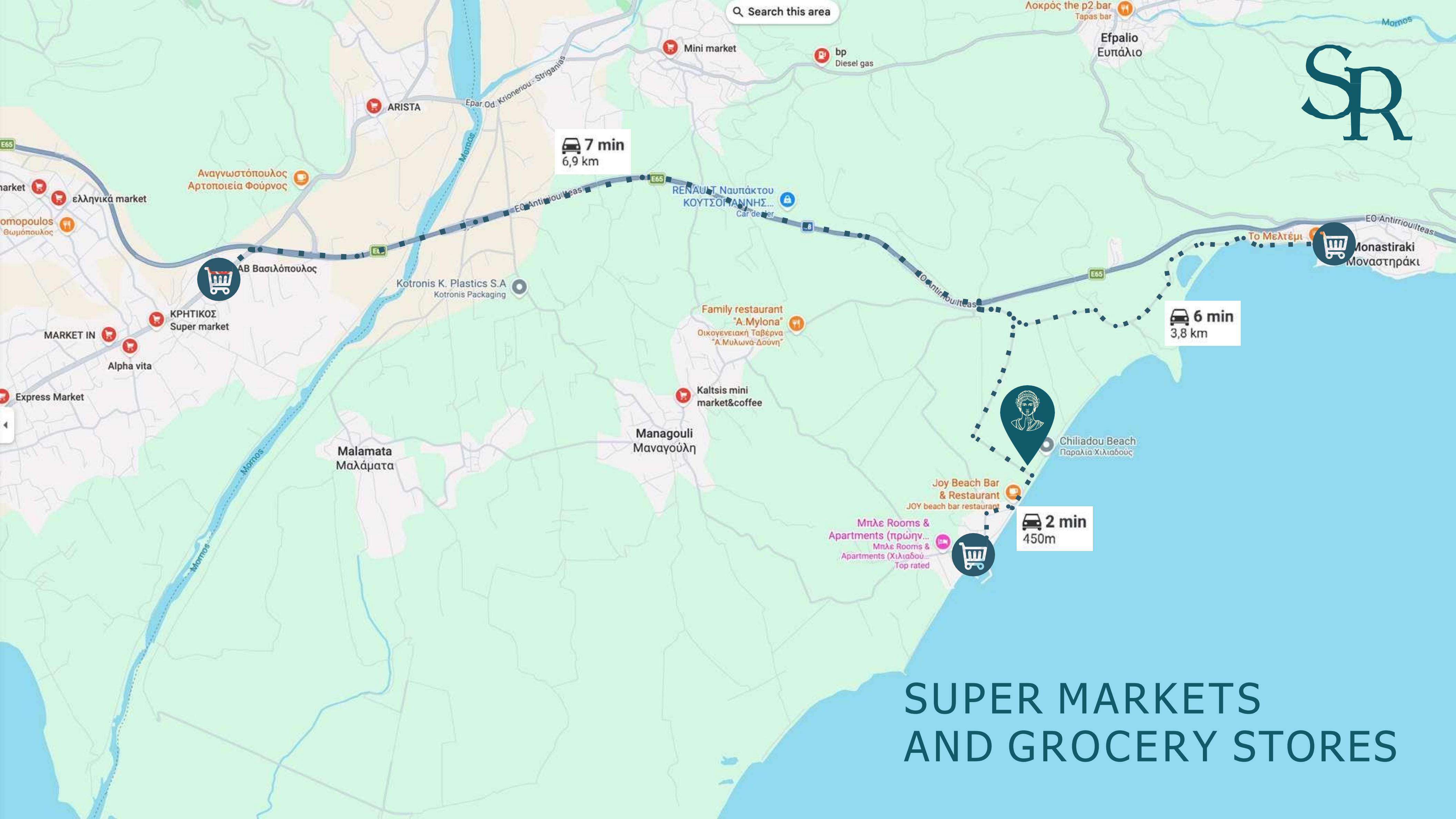

# SUPER MARKETS AND GROCERY STORES

# WHY CHILIADOU?



*A breathtaking coastline  
with crystal-clear waters  
and pristine beaches — the  
perfect retreat for families.*



Real People



Real Experience



Real Feelings



Real Grecce



2.5 hours from Athens.  
Easy to reach.  
Hard to leave.



SR

# EXPERIENCES



## CULTURAL IMMERSION

- Ancient Delphi (UNESCO World Heritage)
- Traditional villages of Galaxidi and Itea
- Byzantine monasteries in the mountains
- Local tavernas serving authentic cuisine

# EXPERIENCES



## NATURE & RELAXATION

- Blue Flag beaches steps away
- Private pools
- Hiking through olive groves
- Kayaking in protected bays



# EXPERIENCES

## CASTRONOMY

- Famous Amfissa olives
- Fresh seafood from the gulf
- Local cheeses and mountain honey
- Wine tastings in historic cellars

The logo consists of the letters 'S' and 'R' in a stylized, white, serif font, positioned in the upper right corner of the image.

# LIFESTYLE

## MORNING

**Wake to the sound of gentle waves.  
Coffee on your private terrace.  
The gulf stretching to the horizon.**

## DAY

**Explore ancient Delphi.  
Swim in crystal-clear waters.  
Discover charming Galaxidi.**

## EVENING

**Sunset from your private pool.  
Local wine and fresh seafood.  
Stars reflecting on the water.**

**This is how life should be lived.**



SR

THE RESIDENCES



# MODERN ARCHITECTURE WITH CHARACTER

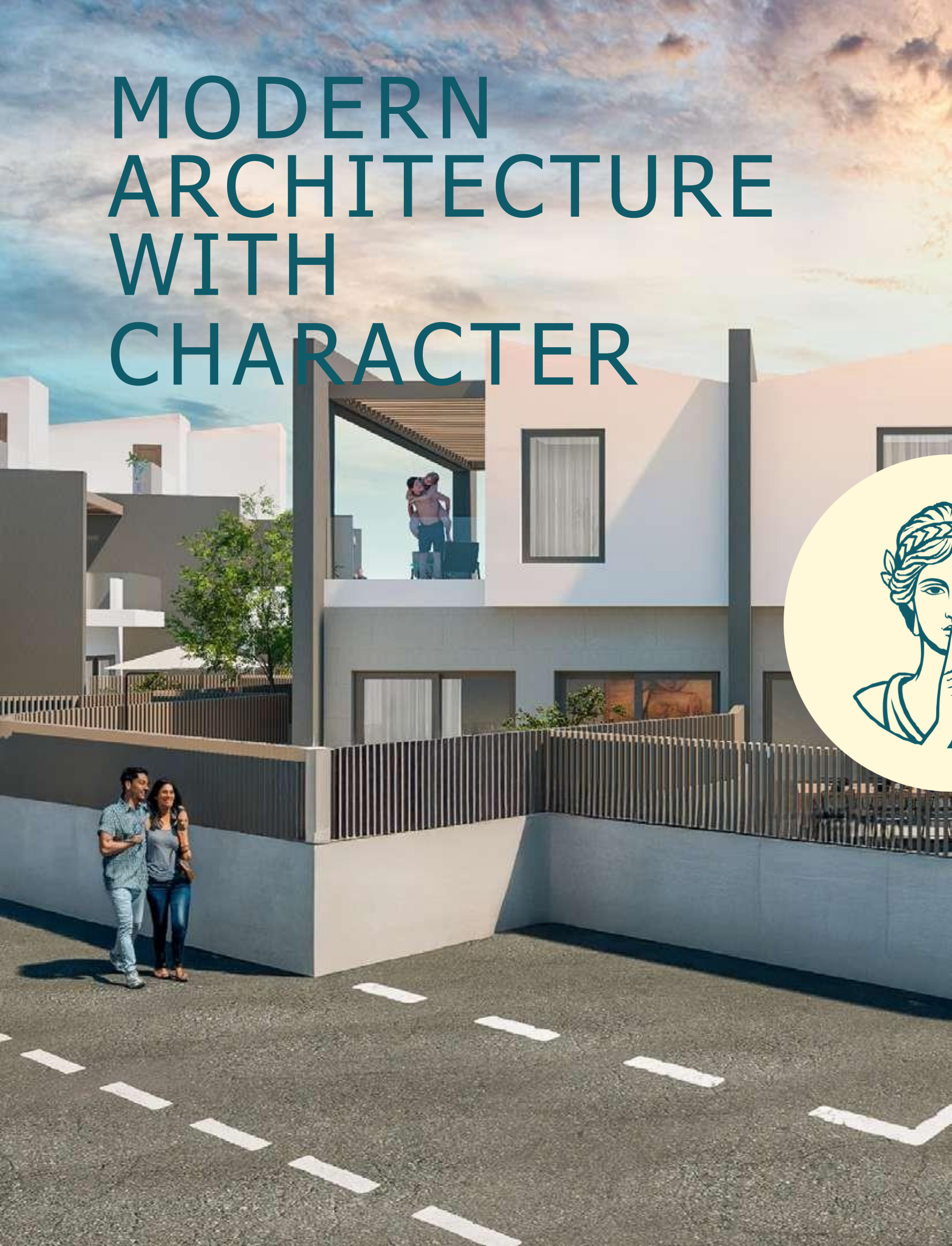

SR





SR

# PRIVATE POOLS

SR





# PANORAMIC VIEWS



COMFORT THROUGHOUT THE YEAR



SR



SR



# THE INTERIOR

The interior is a perfect blend of natural elegance and Mediterranean calm — soft textures, earthy tones, and curated details create a space that feels both refined and effortlessly relaxing.

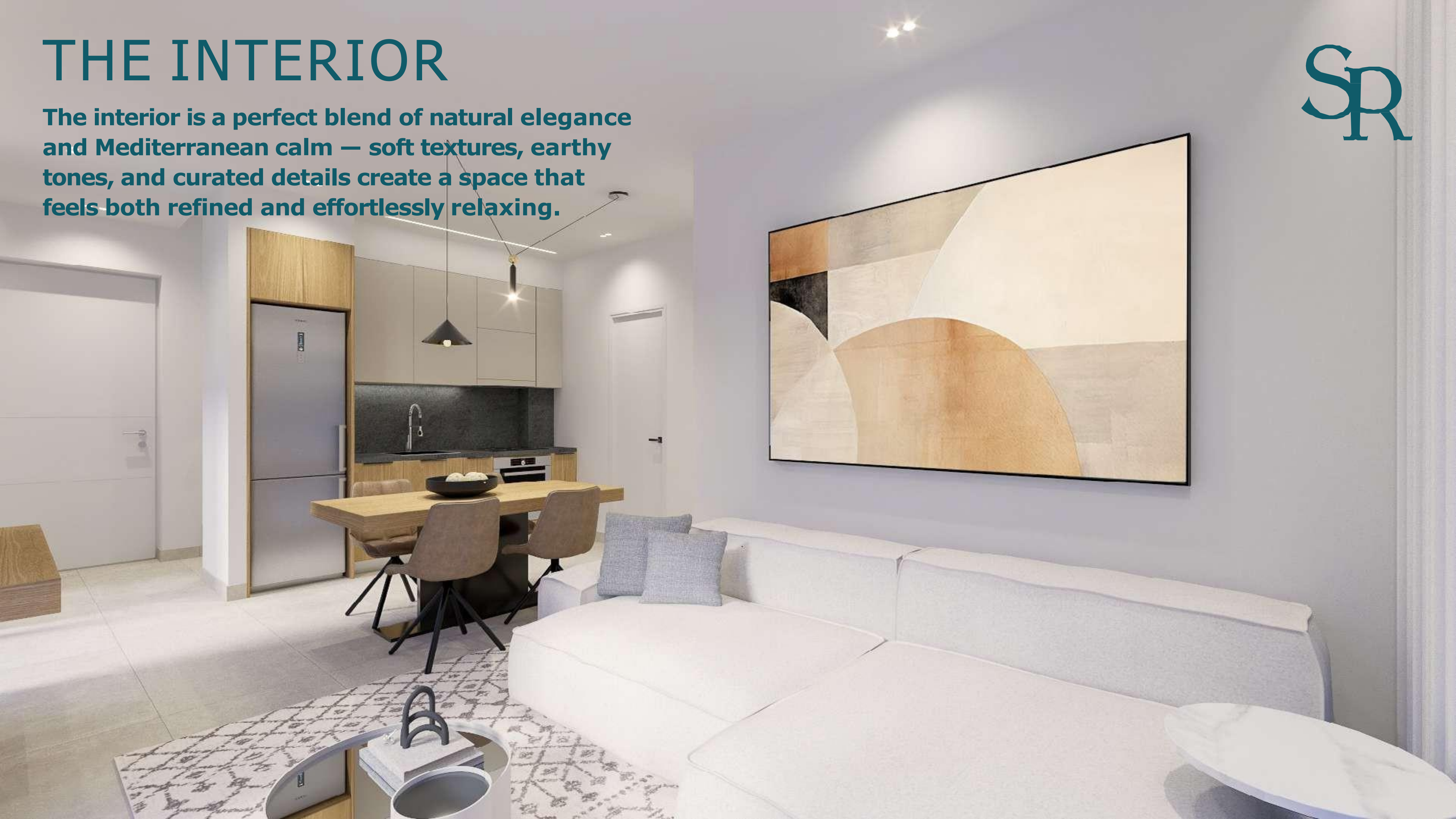





PLOT A

PLOT B

PLOT C

PLOT D

PLOT E

PLOT F

SR

# PLOT A

YE HONATAN

**1** Total Plot **285.92m<sup>2</sup>**

Outdoor area	196.80m <sup>2</sup>
Bedrooms	5
Bathrooms	3
Ground floor	89.12m <sup>2</sup>
Upper floor	92.81m <sup>2</sup>
Attic	30.09m <sup>2</sup>
Total Area	212.02m <sup>2</sup>
Balcony	27.75m <sup>2</sup>
Roof Terrace	8.11m <sup>2</sup>
Swimming Pool	Yes
Parking Spot	Yes

YE HONATAN

**2** Total Plot **231.23m<sup>2</sup>**

Outdoor area	141.23m <sup>2</sup>
Bedrooms	5
Bathrooms	3
Ground floor	90.00m <sup>2</sup>
Upper floor	93.19m <sup>2</sup>
Attic	30.09m <sup>2</sup>
Total Area	213.28m <sup>2</sup>
Balcony	24.78m <sup>2</sup>
Roof Terrace	8.11m <sup>2</sup>
Swimming Pool	Yes
Parking Spot	Yes

TAI

**3** Total Plot **122.23m<sup>2</sup>**

Outdoor area2	70.16m <sup>2</sup>
Bedrooms	2
Bathrooms	2
Ground floor	52.07m <sup>2</sup>
Upper floor	32.40m <sup>2</sup>
Total Area	84.47m <sup>2</sup>
Balcony	22.43m <sup>2</sup>
Swimming Pool	Yes
Parking Spot	Yes

TAI

**4** Total Plot **146.47m<sup>2</sup>**

Outdoor area	94.40m <sup>2</sup>
Bedrooms	2
Bathrooms	2
Ground floor	52.07m <sup>2</sup>
Upper floor	32.40m <sup>2</sup>
Total Area	84.47m <sup>2</sup>
Balcony	22.43m <sup>2</sup>
Swimming Pool	Yes
Parking Spot	Yes

SEA VIEW

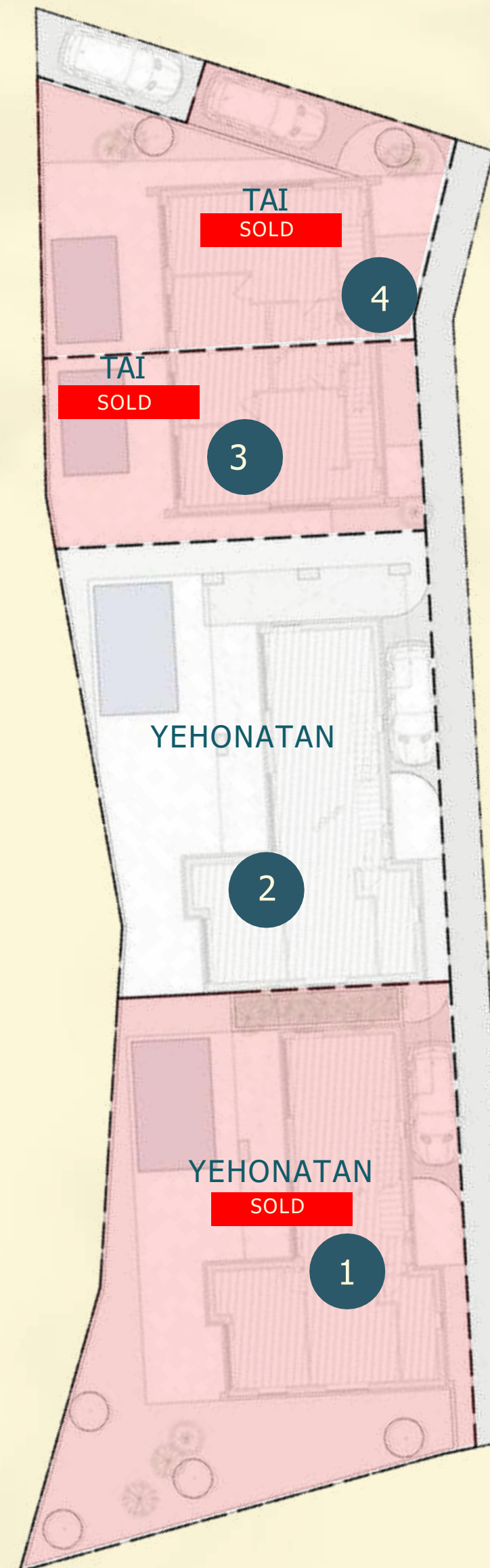

MOUNTAIN VIEW

# PLOT B

**1** **YAIR**

<b>Total Plot</b>	<b>183.50m<sup>2</sup></b>
Outdoor area	124.42m <sup>2</sup>
Bedrooms	3
Bathrooms	2
Ground floor	59.08m <sup>2</sup>
Upper floor	66.22m <sup>2</sup>
Attic	15.96m <sup>2</sup>
Total Area	141.26m <sup>2</sup>
Balcony	10.42m <sup>2</sup>
Roof Terrace	10.75m <sup>2</sup>
Swimming Pool	Yes
Parking Spot	Yes

**2** **YAIR**

<b>Total Plot</b>	<b>139.32m<sup>2</sup></b>
Outdoor area	80.23m <sup>2</sup>
Bedrooms	3
Bathrooms	2
Ground floor	59.09m <sup>2</sup>
Upper floor	66.22m <sup>2</sup>
Attic	15.96m <sup>2</sup>
Total Area	141.27m <sup>2</sup>
Balcony	10.42m <sup>2</sup>
Roof Terrace	10.75m <sup>2</sup>
Swimming Pool	Yes
Parking Spot	Yes

**3** **YAIR**

<b>Total Plot</b>	<b>168.16m<sup>2</sup></b>
Outdoor area	104.98m <sup>2</sup>
Bedrooms	3
Bathrooms	2
Ground floor	63.18m <sup>2</sup>
Upper floor	70.94m <sup>2</sup>
Attic	15.96m <sup>2</sup>
Total Area	150.08m <sup>2</sup>
Balcony	10.57m <sup>2</sup>
Roof Terrace	12.50m <sup>2</sup>
Swimming Pool	Yes
Parking Spot	Yes

**4** **TAI**

<b>Total Plot</b>	<b>138.67m<sup>2</sup></b>
Outdoor area	86.60m <sup>2</sup>
Bedrooms	2
Bathrooms	2
Ground floor	52.07m <sup>2</sup>
Upper floor	32.40m <sup>2</sup>
Total Area	84.47m <sup>2</sup>
Balcony	22.43m <sup>2</sup>
Swimming Pool	Yes
Parking Spot	Yes

**5** **TAI**

<b>Total Plot</b>	<b>143.70m<sup>2</sup></b>
Outdoor area	91.63m <sup>2</sup>
Bedrooms	2
Bathrooms	2
Ground floor	52.07m <sup>2</sup>
Upper floor	32.40m <sup>2</sup>
Total Area	84.47m <sup>2</sup>
Balcony	22.43m <sup>2</sup>
Swimming Pool	Yes
Parking Spot	Yes

SEA VIEW

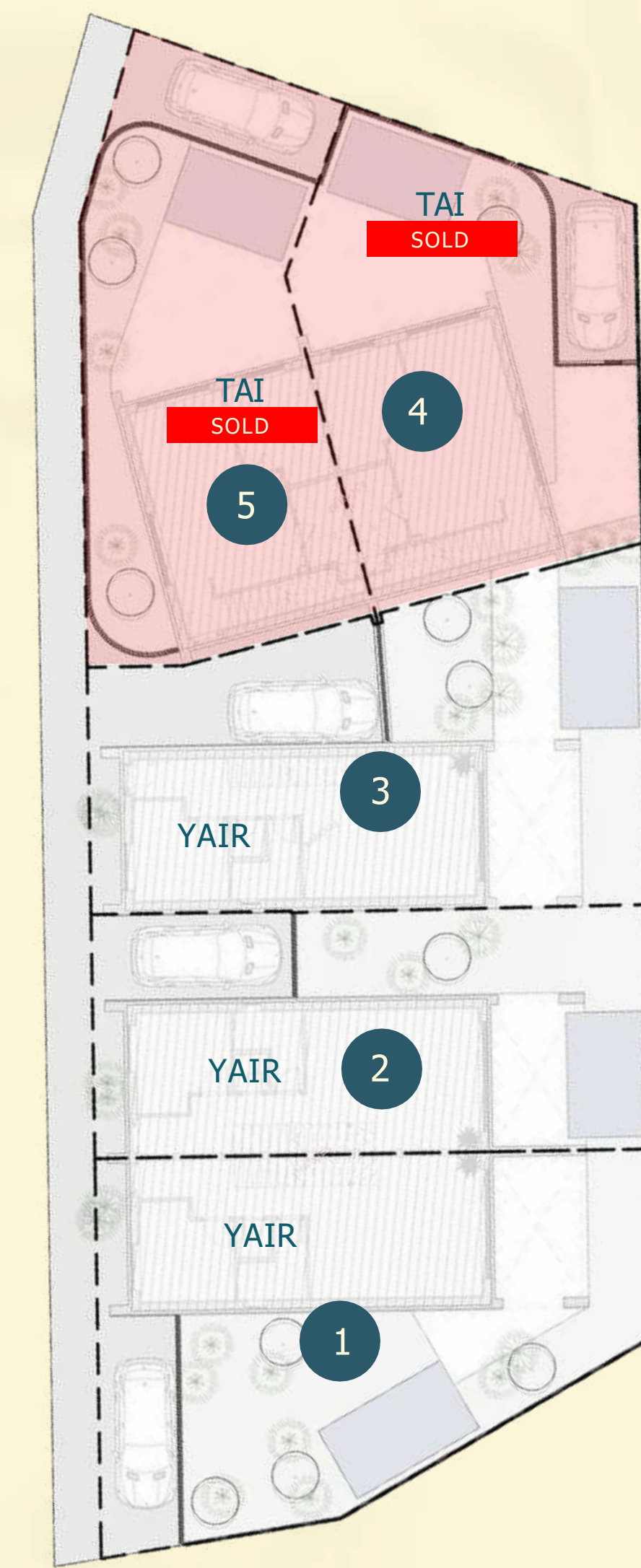

MOUNTAIN VIEW

# PLOT C

**1** **MICHAL**

Total Plot	<b>205.97m<sup>2</sup></b>
Outdoor area	145.92m <sup>2</sup>
Bedrooms	3
Bathrooms	2
Ground floor	60.05m <sup>2</sup>
Upper floor	60.51m <sup>2</sup>
Attic	16.67m <sup>2</sup>
Total Area	137.23m <sup>2</sup>
Balcony	15.33m <sup>2</sup>
Roof Terrace	16.34m <sup>2</sup>
Swimming Pool	Yes
Parking Spot	Yes

**2** **MICHAL**

Total Plot	<b>136.81m<sup>2</sup></b>
Outdoor area	79.96m <sup>2</sup>
Bedrooms	3
Bathrooms	2
Ground floor	56.85m <sup>2</sup>
Upper floor	57.31m <sup>2</sup>
Attic	15.35m <sup>2</sup>
Total Area	129.51m <sup>2</sup>
Balcony	14.86m <sup>2</sup>
Roof Terrace	14.78m <sup>2</sup>
Swimming Pool	Yes
Parking Spot	Yes

**3** **MICHAL**

Total Plot	<b>137.59m<sup>2</sup></b>
Outdoor area	77.54m <sup>2</sup>
Bedrooms	3
Bathrooms	2
Ground floor	60.05m <sup>2</sup>
Upper floor	60.53m <sup>2</sup>
Attic	17.82m <sup>2</sup>
Total Area	138.40m <sup>2</sup>
Balcony	14.86m <sup>2</sup>
Roof Terrace	16.47m <sup>2</sup>
Swimming Pool	Yes
Parking Spot	Yes

**4** **TAI**

Total Plot	<b>158.86m<sup>2</sup></b>
Outdoor area	106.79m <sup>2</sup>
Bedrooms	2
Bathrooms	2
Ground floor	52.07m <sup>2</sup>
Upper floor	32.40m <sup>2</sup>
Total Area	84.47m <sup>2</sup>
Balcony	22.31m <sup>2</sup>
Swimming Pool	Yes
Parking Spot	Yes

**5** **TAI**

Total Plot	<b>158.54m<sup>2</sup></b>
Outdoor area	106.47m <sup>2</sup>
Bedrooms	2
Bathrooms	2
Ground floor	52.07m <sup>2</sup>
Upper floor	32.40m <sup>2</sup>
Total Area	84.47m <sup>2</sup>
Balcony	22.31m <sup>2</sup>
Swimming Pool	Yes
Parking Spot	Yes

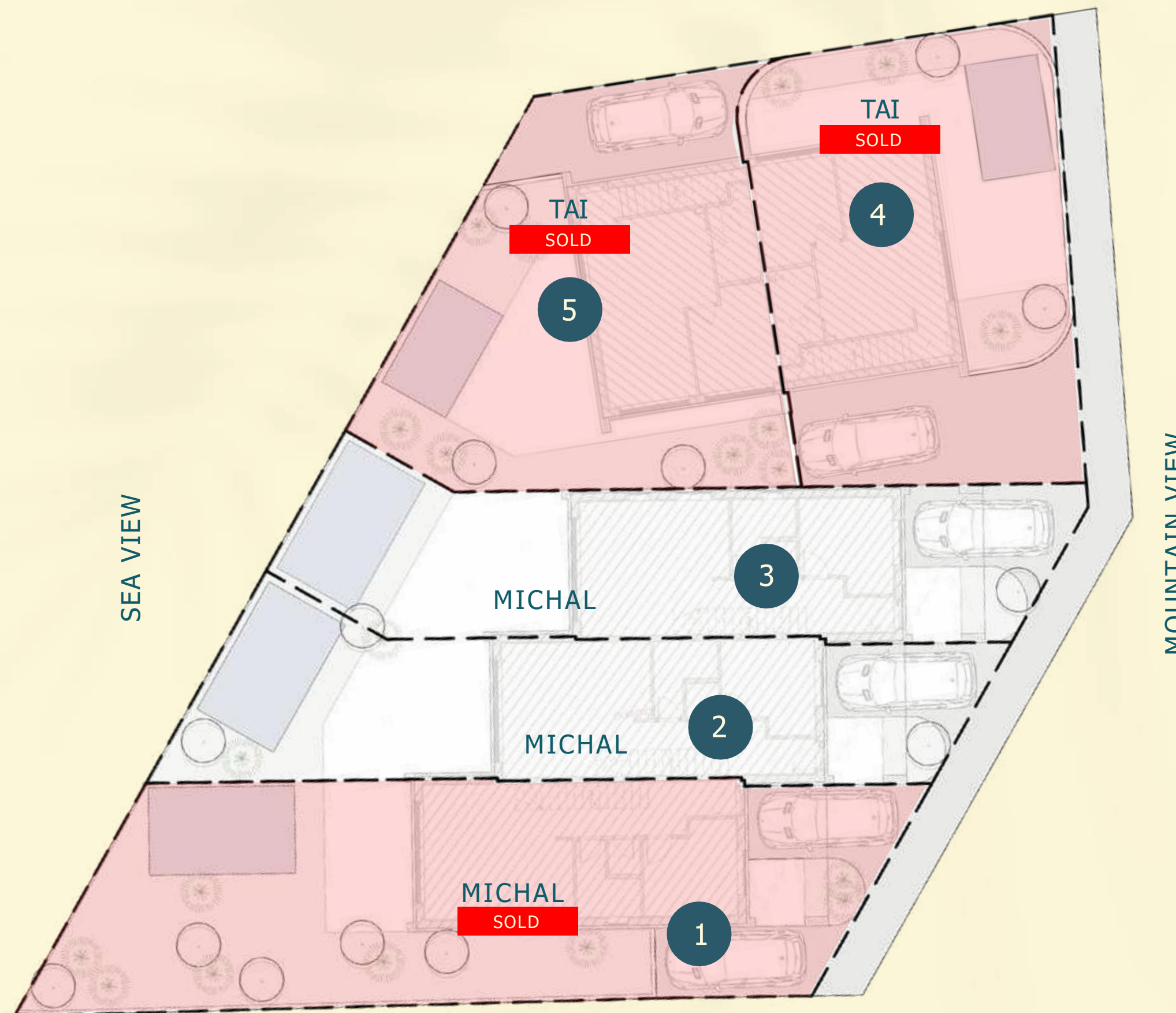

# PLOT D

**1** MICHAL

**Total Plot 217.03m<sup>2</sup>**

Outdoor area	154.71m <sup>2</sup>
Bedrooms	3
Bathrooms	2
Ground floor	62.32m <sup>2</sup>
Upper floor	56.61m <sup>2</sup>
Attic	14.36m <sup>2</sup>
Total Area	133.29m <sup>2</sup>
Balcony	14.89m <sup>2</sup>
Roof Terrace	13.01m <sup>2</sup>
Swimming Pool	Yes
Parking Spot	Yes

**3** MICHAL

**Total Plot 144.51m<sup>2</sup>**

Outdoor area	81.70m <sup>2</sup>
Bedrooms	3
Bathrooms	2
Ground floor	62.81m <sup>2</sup>
Upper floor	57.16m <sup>2</sup>
Attic	13.28m <sup>2</sup>
Total Area	133.25m <sup>2</sup>
Balcony	15.19m <sup>2</sup>
Roof Terrace	13.01m <sup>2</sup>
Swimming Pool	Yes
Parking Spot	Yes

**2** MICHAL

**Total Plot 115.38m<sup>2</sup>**

Outdoor area	56.77m <sup>2</sup>
Bedrooms	3
Bathrooms	2
Ground floor	58.61m <sup>2</sup>
Upper floor	53.99m <sup>2</sup>
Attic	7.92m <sup>2</sup>
Total Area	120.52m <sup>2</sup>
Balcony	14.65m <sup>2</sup>
Roof Terrace	14.94m <sup>2</sup>
Swimming Pool	Yes
Parking Spot	Yes

**4** MICHAL

**Total Plot 133.00m<sup>2</sup>**

Outdoor area	70.69m <sup>2</sup>
Bedrooms	2
Bathrooms	2
Ground floor	62.31m <sup>2</sup>
Upper floor	56.70m <sup>2</sup>
Attic	12.77m <sup>2</sup>
Total Area	131.78m <sup>2</sup>
Balcony	15.53m <sup>2</sup>
Roof Terrace	13.01m <sup>2</sup>
Swimming Pool	Yes
Parking Spot	Yes

**5** MICHAL

**Total Plot 160.05m<sup>2</sup>**

Outdoor area	97.74m <sup>2</sup>
Bedrooms	2
Bathrooms	2
Ground floor	62.31m <sup>2</sup>
Upper floor	56.70m <sup>2</sup>
Attic	12.77m <sup>2</sup>
Total Area	131.78m <sup>2</sup>
Balcony	15.53m <sup>2</sup>
Roof Terrace	13.01m <sup>2</sup>
Swimming Pool	Yes
Parking Spot	Yes

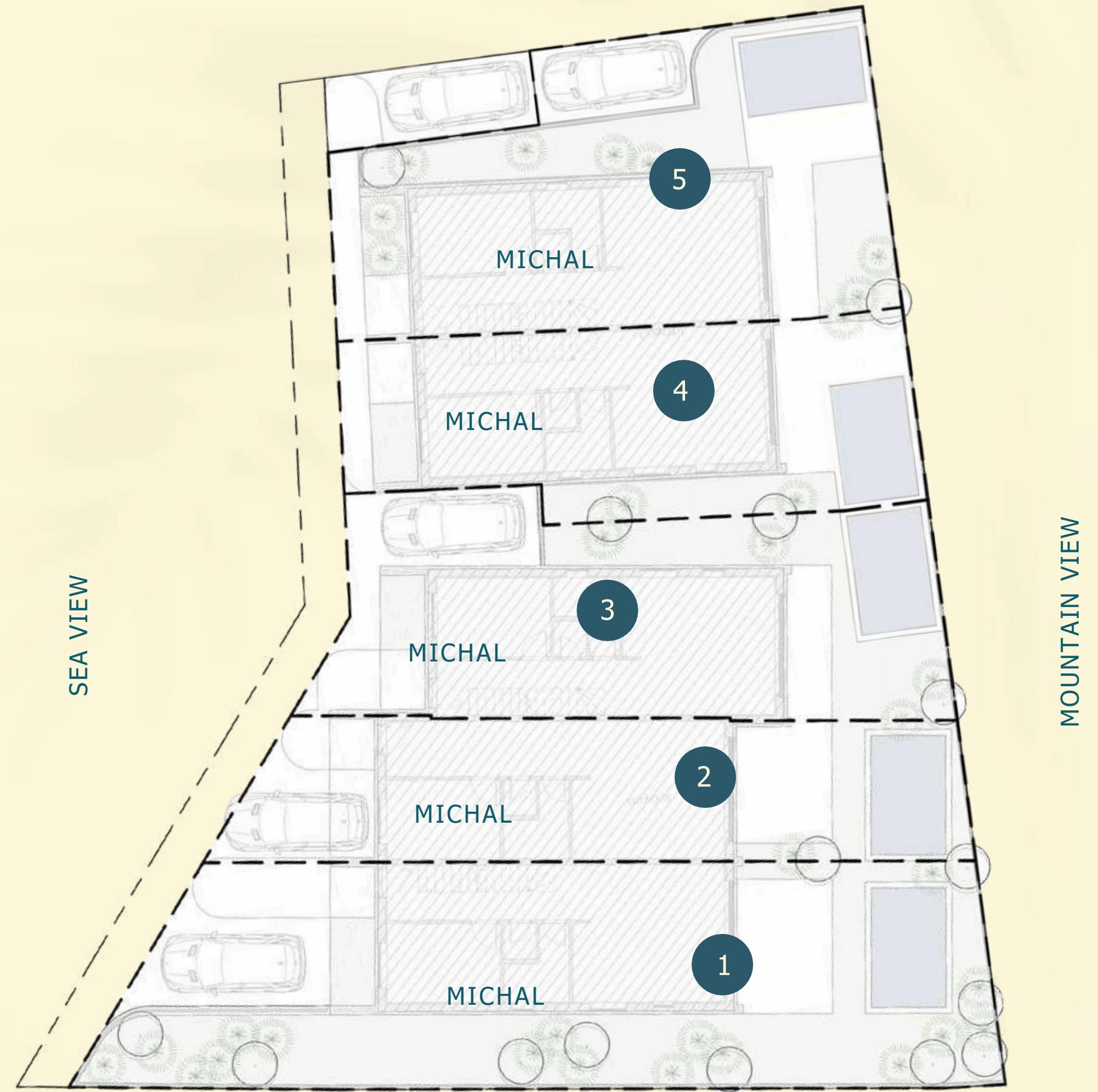

# PLOT E

## GROUND FLOOR APARTMENTS

**1** LOLA

Total Plot	<b>112.19m<sup>2</sup></b>
Outdoor area	60.71m <sup>2</sup>
Bedrooms	1
Bathrooms	1
Ground floor	51.48m <sup>2</sup>
Total Area	51.48m <sup>2</sup>
Swimming Pool	Yes
Parking Spot	Yes

**2** LOLA

Total Plot	<b>100.60m<sup>2</sup></b>
Outdoor area	49.12m <sup>2</sup>
Bedrooms	1
Bathrooms	1
Ground floor	51.48m <sup>2</sup>
Total Area	51.48m <sup>2</sup>
Swimming Pool	Yes
Parking Spot	Yes

**3** LOLA

Total Plot	<b>99.91m<sup>2</sup></b>
Outdoor area	48.43m <sup>2</sup>
Bedrooms	1
Bathrooms	1
Ground floor	51.48m <sup>2</sup>
Total Area	51.48m <sup>2</sup>
Swimming Pool	Yes
Parking Spot	Yes

**4** LOLA

Total Plot	<b>78.85m<sup>2</sup></b>
Outdoor area	30.34m <sup>2</sup>
Bedrooms	1
Bathrooms	1
Ground floor	48.51m <sup>2</sup>
Total Area	48.51m <sup>2</sup>
Swimming Pool	Yes
Parking Spot	Yes

**5** LOLA

Total Plot	<b>81.76m<sup>2</sup></b>
Outdoor area	30.28m <sup>2</sup>
Bedrooms	1
Bathrooms	1
Ground floor	51.48m <sup>2</sup>
Total Area	51.48m <sup>2</sup>
Swimming Pool	Yes
Parking Spot	Yes

SEA VIEW

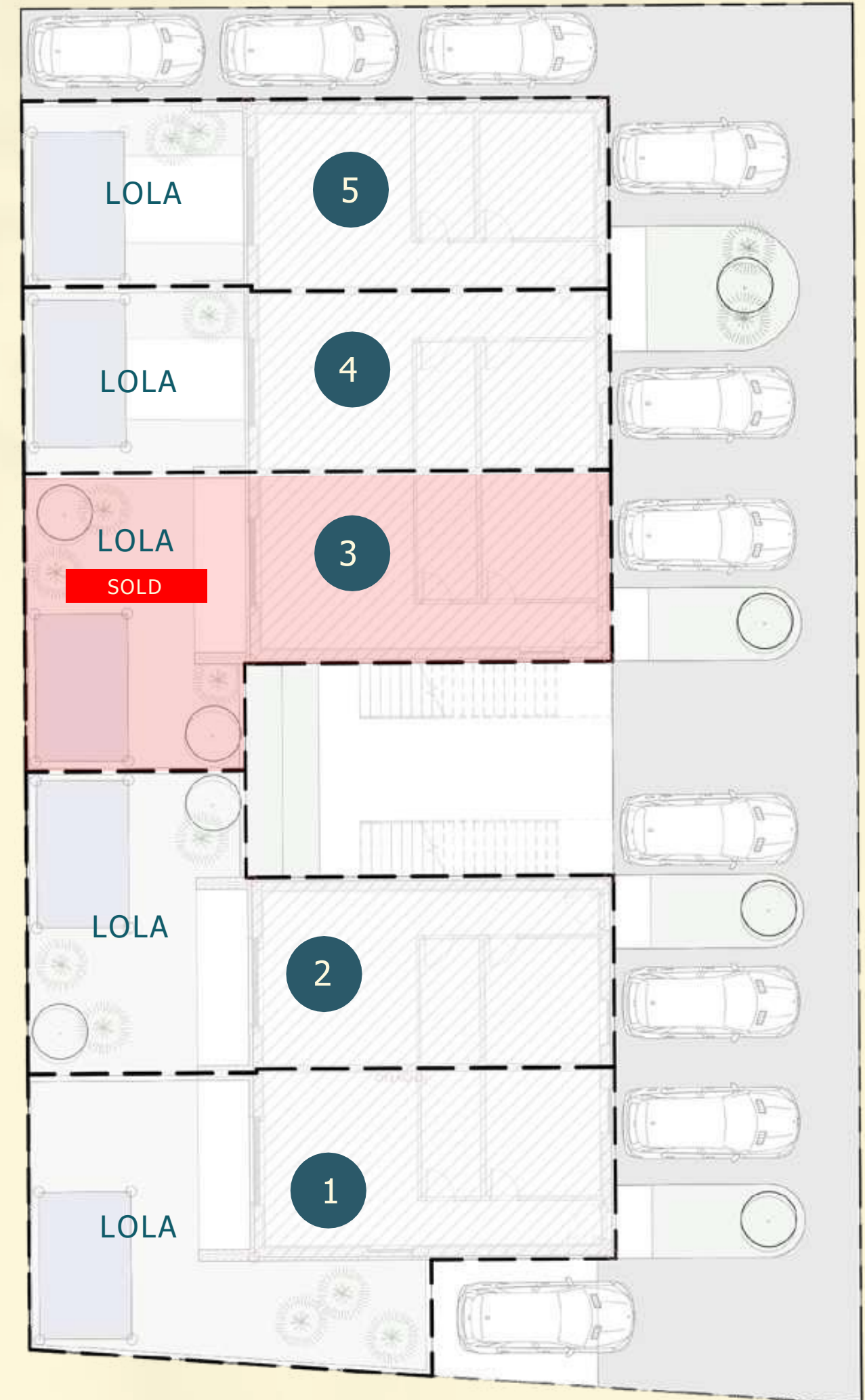

MOUNTAIN VIEW

# PLOT E

## 1ST FLOOR APARTMENTS

1

MIKA

Bedrooms	1
Bathrooms	1
Floor	38.41m <sup>2</sup>
Attic	23.85m <sup>2</sup>
Total Area	62.26m <sup>2</sup>
Balcony	18.26m <sup>2</sup>
Roof Terrace	7.35m <sup>2</sup>
Swimming Pool	No
Parking Spot	Yes

4

MIKA

Bedrooms	1
Bathrooms	1
Floor	38.41m <sup>2</sup>
Attic	23.85m <sup>2</sup>
Total Area	62.26m <sup>2</sup>
Balcony	11.49m <sup>2</sup>
Roof Terrace	10.60m <sup>2</sup>
Swimming Pool	No
Parking Spot	Yes

2

MIKA

Bedrooms	1
Bathrooms	1
Floor	38.54m <sup>2</sup>
Attic	23.40m <sup>2</sup>
Total Area	61.94m <sup>2</sup>
Balcony	10.90m <sup>2</sup>
Roof Terrace	12.63m <sup>2</sup>
Swimming Pool	No
Parking	Yes

5

MIKA

Bedrooms	1
Bathrooms	1
Floor	36.71m <sup>2</sup>
Attic	22.50m <sup>2</sup>
Total Area	59.21m <sup>2</sup>
Balcony	10.45m <sup>2</sup>
Roof Terrace	12.00m <sup>2</sup>
Swimming Pool	No
Parking Spot	Yes

3

MIKA

Bedrooms	1
Bathrooms	1
Floor	38.99m <sup>2</sup>
Attic	23.85m <sup>2</sup>
Total Area	62.84m <sup>2</sup>
Balcony	17.92m <sup>2</sup>
Roof Terrace	7.35m <sup>2</sup>
Swimming Pool	No
Parking Spot	Yes

SEA VIEW

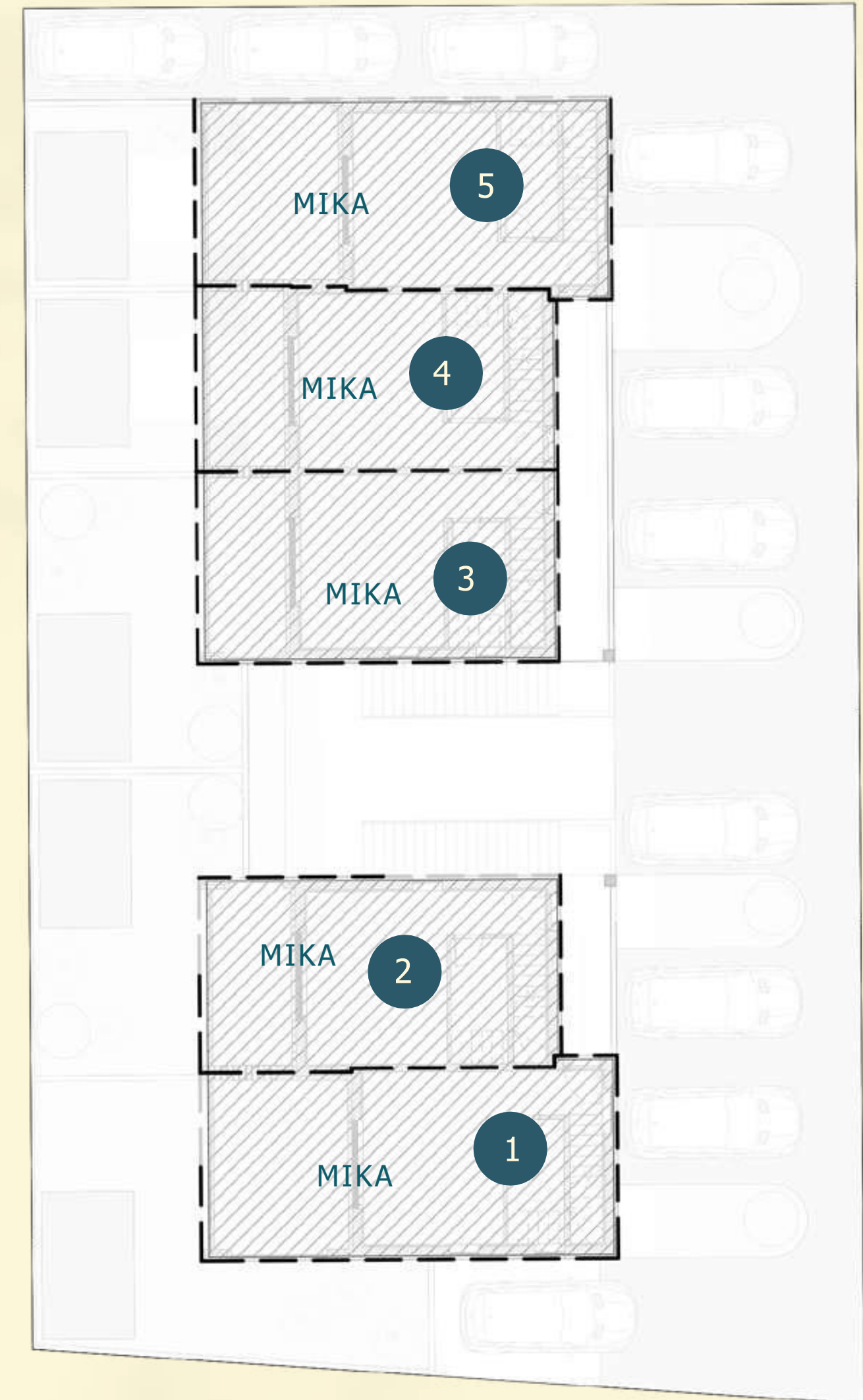

MOUNTAIN VIEW

# PLOT F

## GROUND FLOOR APARTMENTS

**1** LOLA

Total Plot	<b>162.11m<sup>2</sup></b>
Outdoor area	110.63m <sup>2</sup>
Bedrooms	1
Bathrooms	1
Ground floor	51.48m <sup>2</sup>
Total Area	51.48m <sup>2</sup>
Swimming Pool	Yes
Parking Spot	Yes

**2** LOLA

Total Plot	<b>93.81m<sup>2</sup></b>
Outdoor area	45.30m <sup>2</sup>
Bedrooms	1
Bathrooms	1
Ground floor	48.51m <sup>2</sup>
Total Area	48.51m <sup>2</sup>
Swimming Pool	Yes
Parking Spot	Yes

**3** LOLA

Total Plot	<b>122.08m<sup>2</sup></b>
Outdoor area	70.60m <sup>2</sup>
Bedrooms	1
Bathrooms	1
Ground floor	51.48m <sup>2</sup>
Total Area	51.48m <sup>2</sup>
Swimming Pool	Yes
Parking Spot	Yes

**4** LOLA

Total Plot	<b>89.79m<sup>2</sup></b>
Outdoor area	38.31m <sup>2</sup>
Bedrooms	1
Bathrooms	1
Ground floor	51.48m <sup>2</sup>
Total Area	51.48m <sup>2</sup>
Swimming Pool	Yes
Parking Spot	Yes

**5** LOLA

Total Plot	<b>87.84m<sup>2</sup></b>
Outdoor area	36.36m <sup>2</sup>
Bedrooms	1
Bathrooms	1
Ground floor	51.48m <sup>2</sup>
Total Area	51.48m <sup>2</sup>
Swimming Pool	Yes
Parking Spot	Yes

SEA VIEW

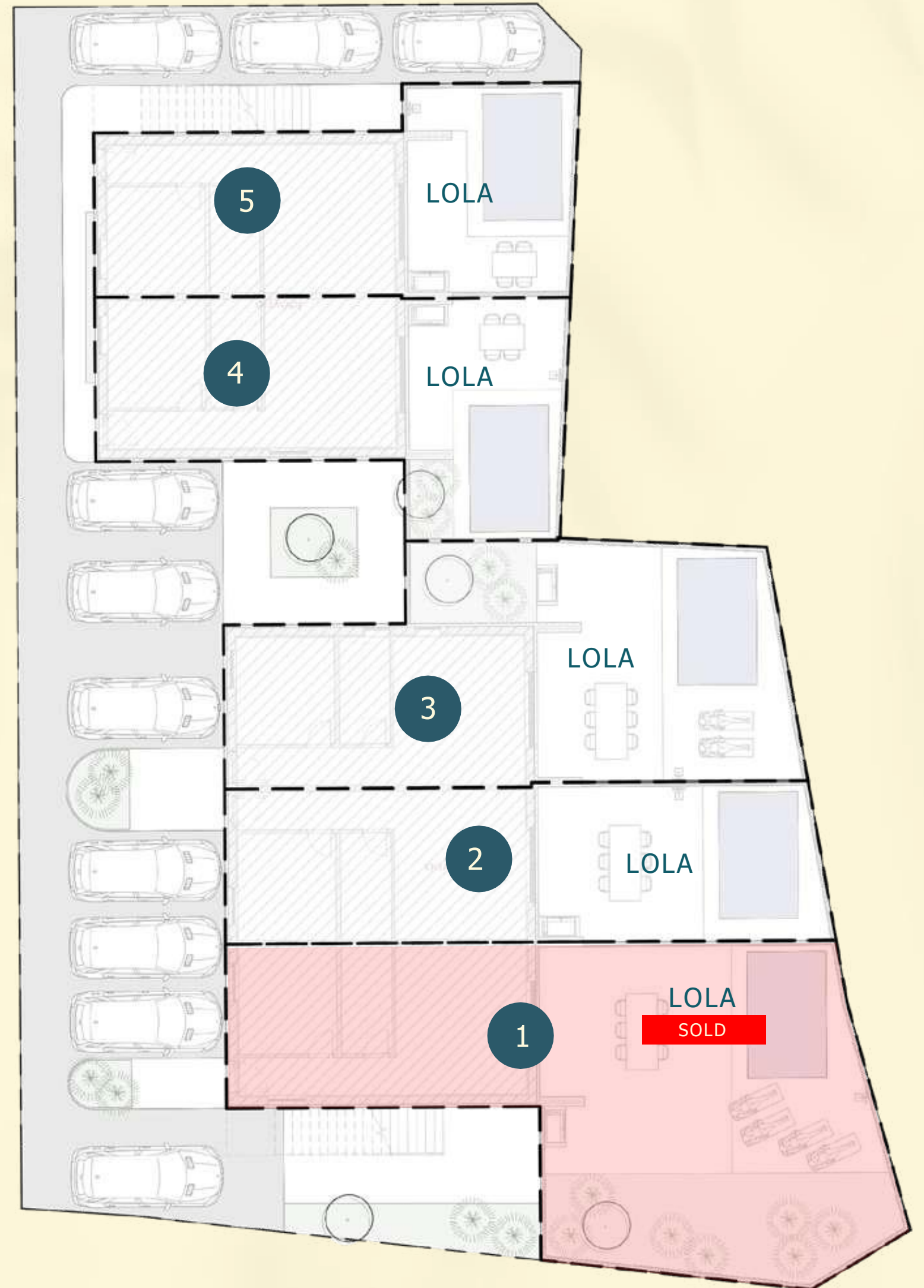

MOUNTAIN VIEW

# PLOT F

## 1ST FLOOR APARTMENTS

1

MIKA

Bedrooms	1
Bathrooms	1
Floor	38.54m <sup>2</sup>
Attic	23.40m <sup>2</sup>
Total Area	61.94m <sup>2</sup>
Balcony	10.90m <sup>2</sup>
Roof Terrace	12.63m <sup>2</sup>
Swimming Pool	No
Parking Spot	Yes

4

MIKA

Bedrooms	1
Bathrooms	1
Floor	36.71m <sup>2</sup>
Attic	22.50m <sup>2</sup>
Total Area	59.21m <sup>2</sup>
Balcony	10.45m <sup>2</sup>
Roof Terrace	12.00m <sup>2</sup>
Swimming Pool	No
Parking Spot	Yes

2

MIKA

Bedrooms	1
Bathrooms	1
Floor	38.99m <sup>2</sup>
Attic	23.85m <sup>2</sup>
Total Area	62.84m <sup>2</sup>
Balcony	17.92m <sup>2</sup>
Roof Terrace	7.35m <sup>2</sup>
Swimming Pool	No
Parking	Yes

5

MIKA

Bedrooms	1
Bathrooms	1
Floor	38.41m <sup>2</sup>
Attic	23.85m <sup>2</sup>
Total Area	62.26m <sup>2</sup>
Balcony	18.26m <sup>2</sup>
Roof Terrace	7.35m <sup>2</sup>
Swimming Pool	No
Parking Spot	Yes

3

MIKA

Bedrooms	1
Bathrooms	1
Floor	38.41m <sup>2</sup>
Attic	23.85m <sup>2</sup>
Total Area	62.26m <sup>2</sup>
Balcony	11.49m <sup>2</sup>
Roof Terrace	10.60m <sup>2</sup>
Swimming Pool	No
Parking Spot	Yes

SEA VIEW

MOUNTAIN VIEW

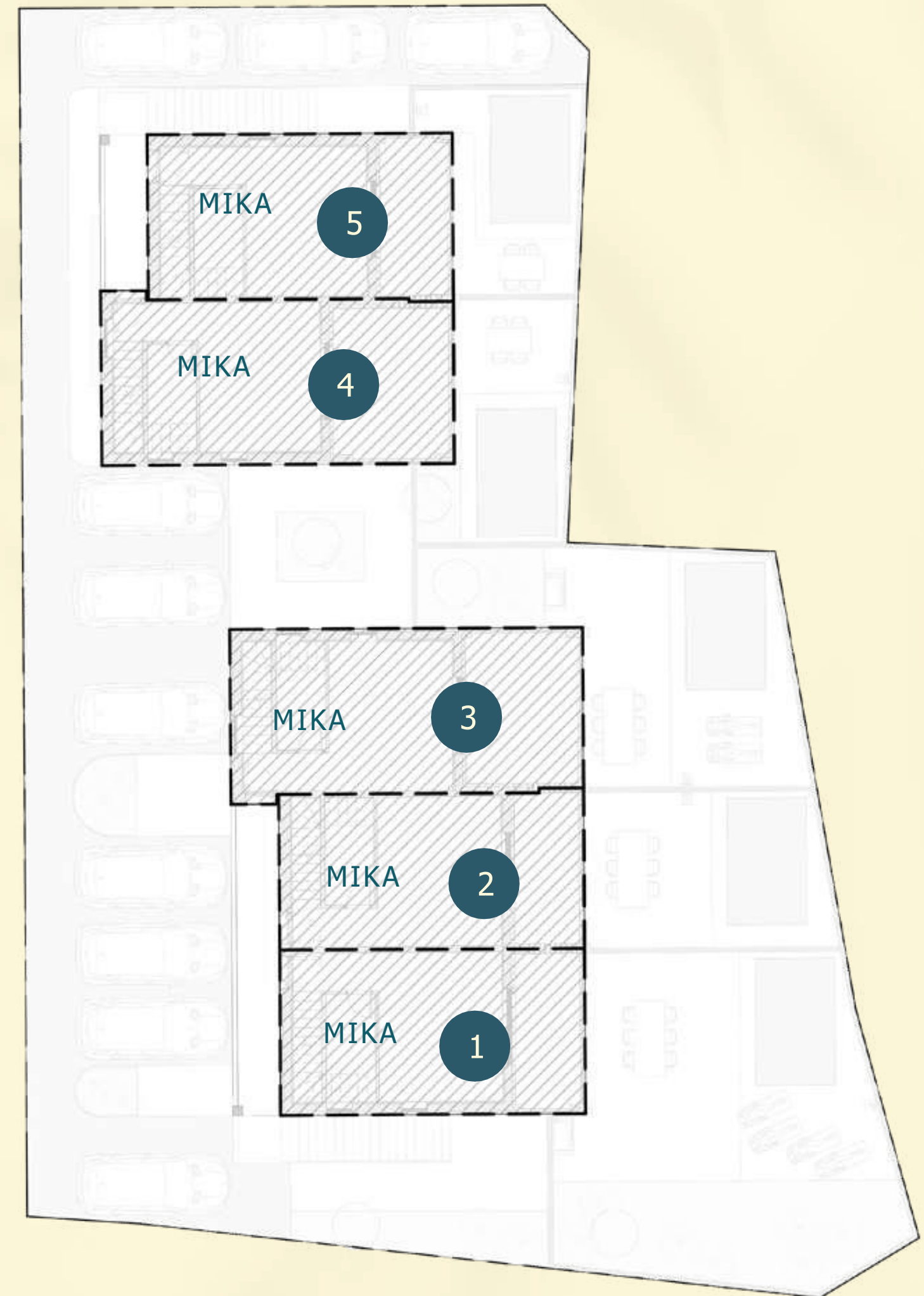

# VILLA TAI





SR



# VILLA TAI TYPICAL PLANS

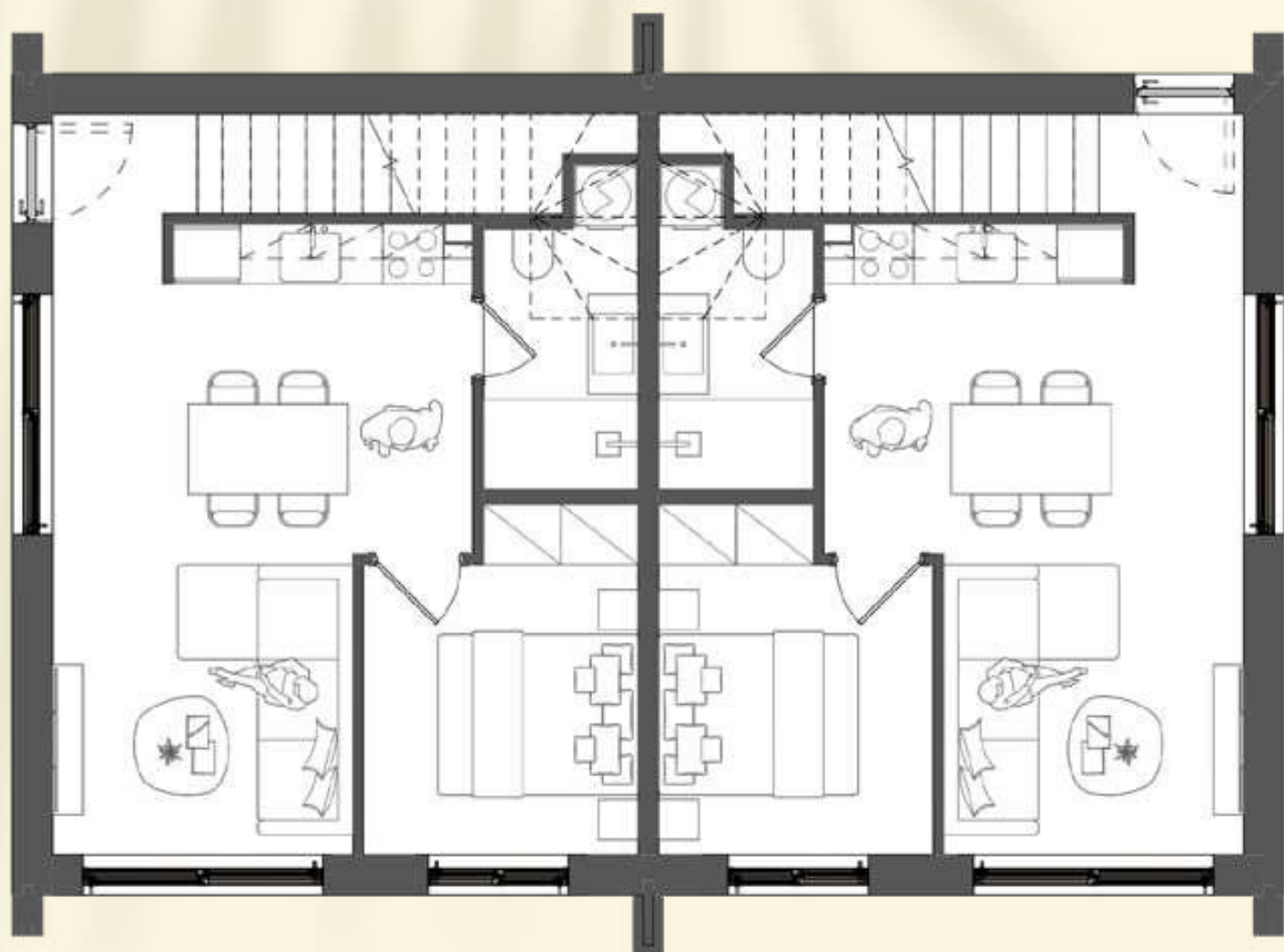

Ground Floor

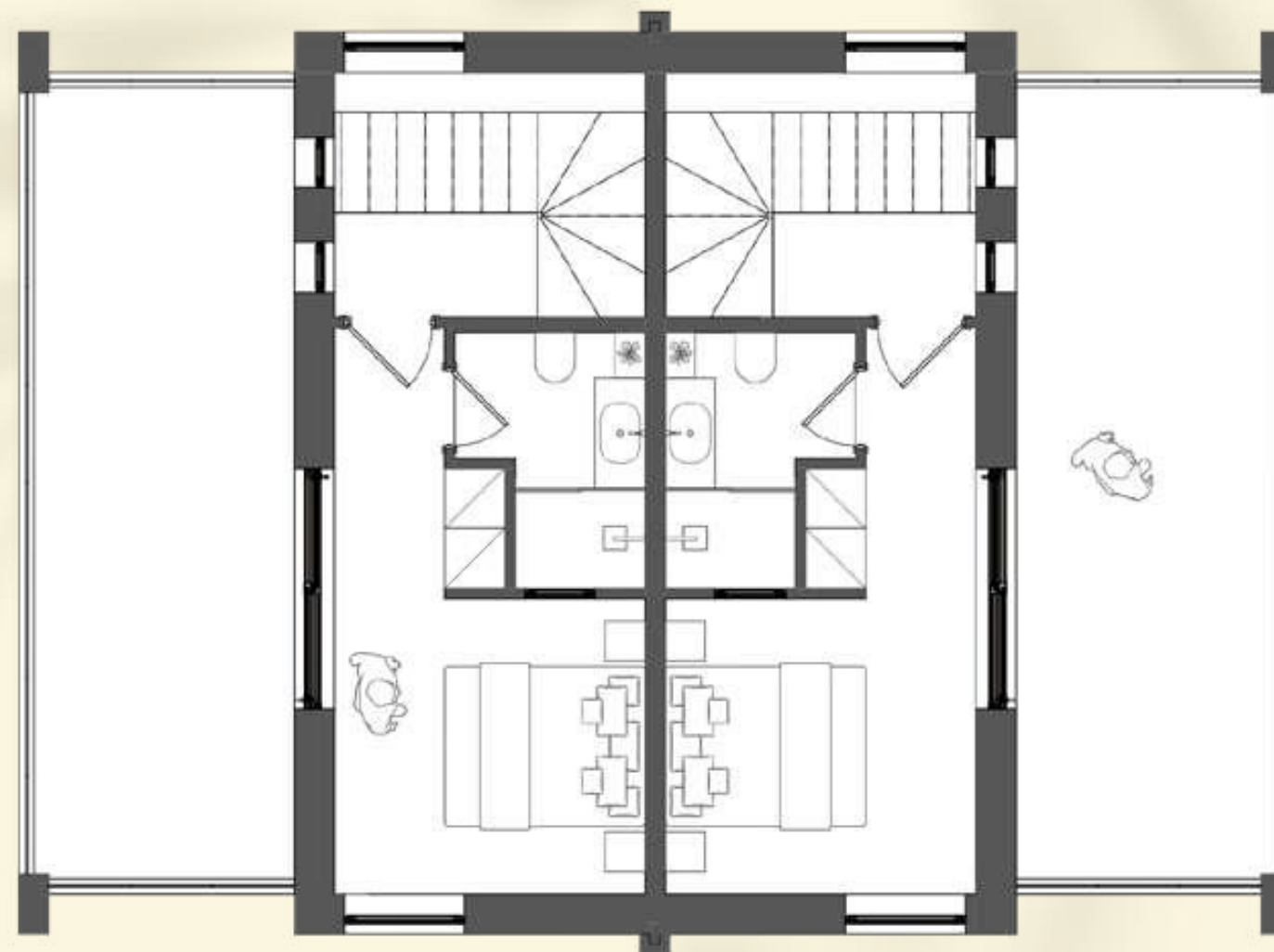

Upper Floor

# VILLA TAI





3D TOUR



# VILLA YEHONATAN



Yehonatan

SR



SR

# VILLA YEHONATAN TYPICAL PLANS

GROUND FLOOR

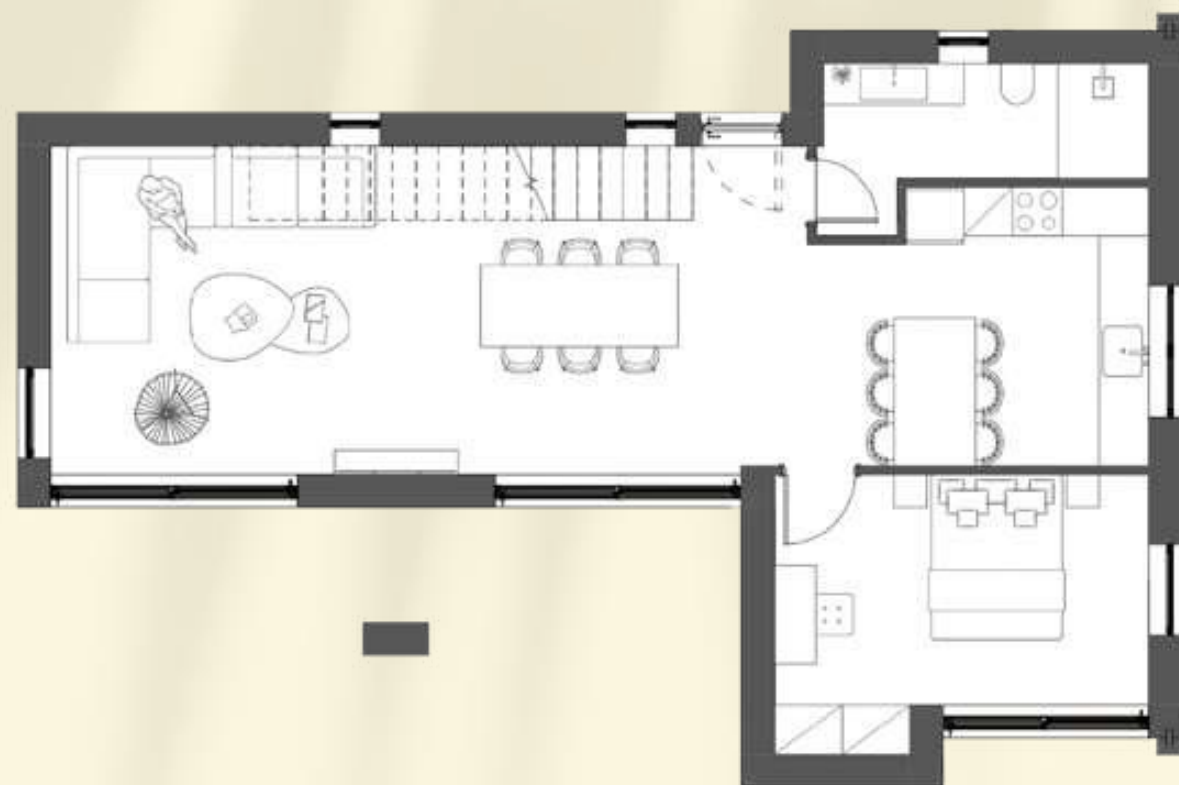

UPPER FLOOR

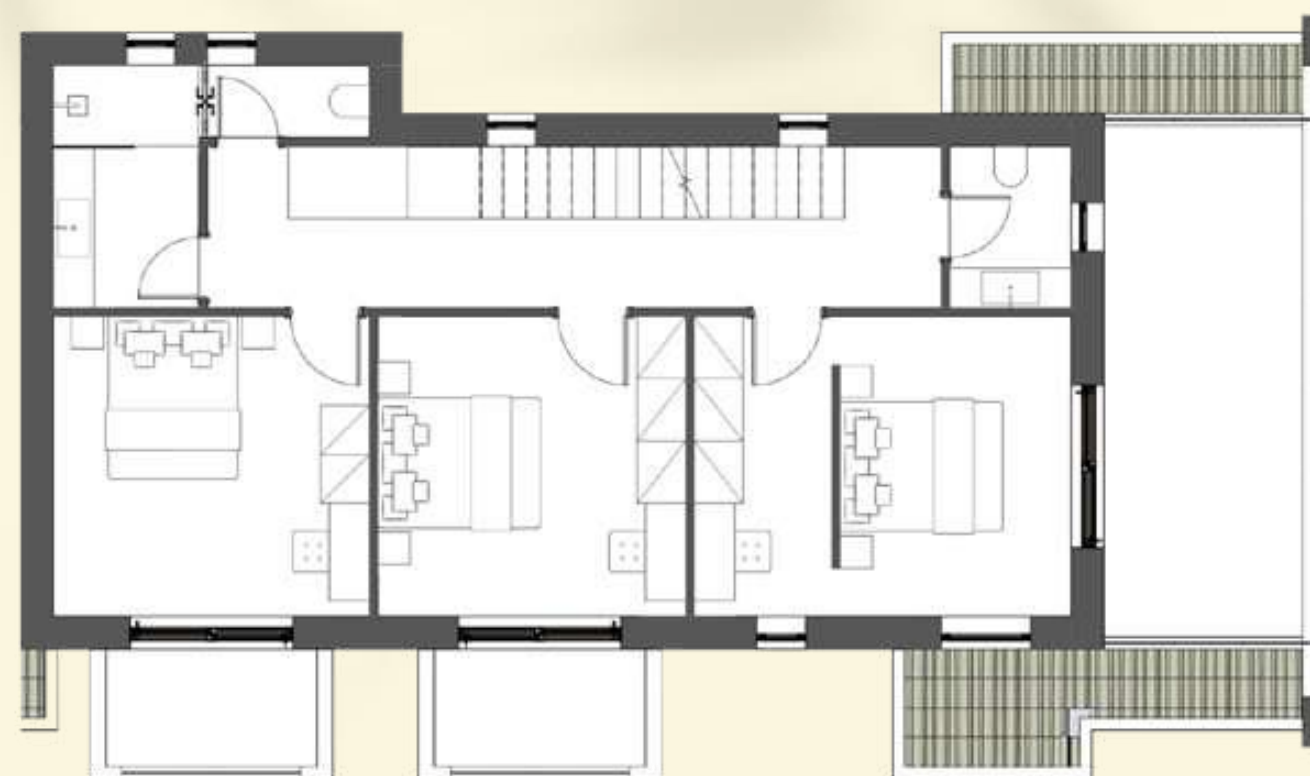

ATTIC

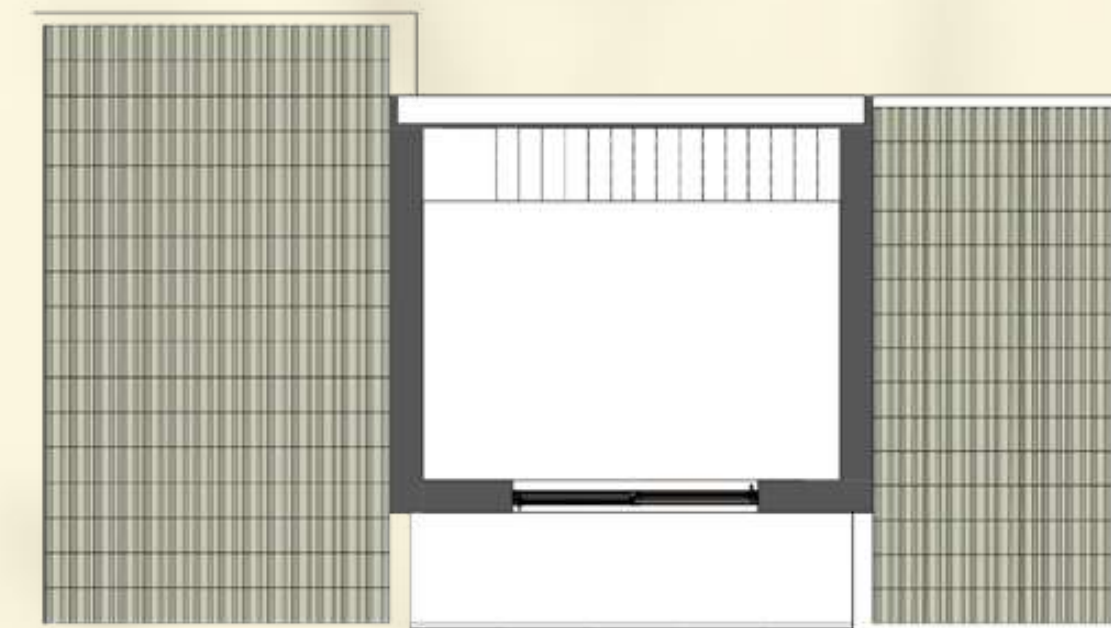



3D TOUR



# VILLA MICHAL



SR



SR



# VILLA MICHAL TYPICAL PLANS

GROUND FLOOR

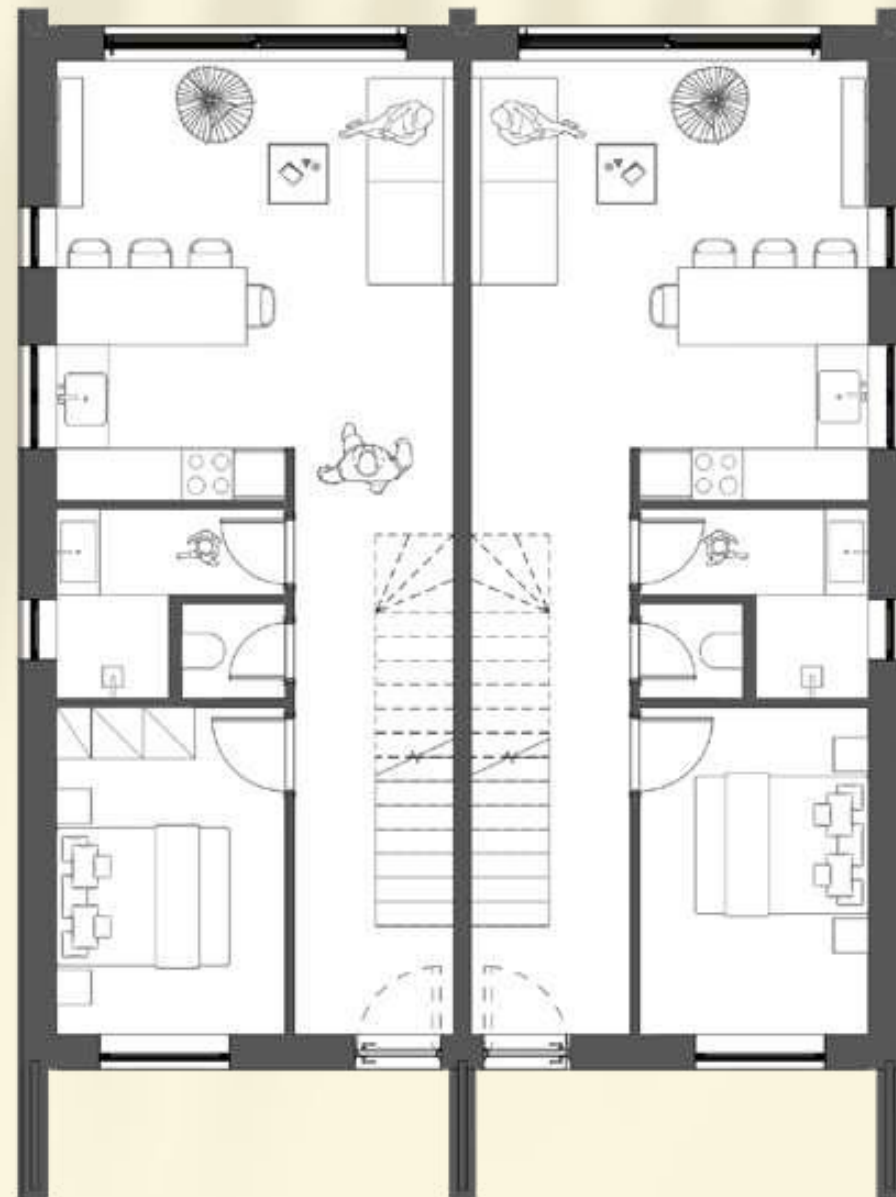

UPPER FLOOR

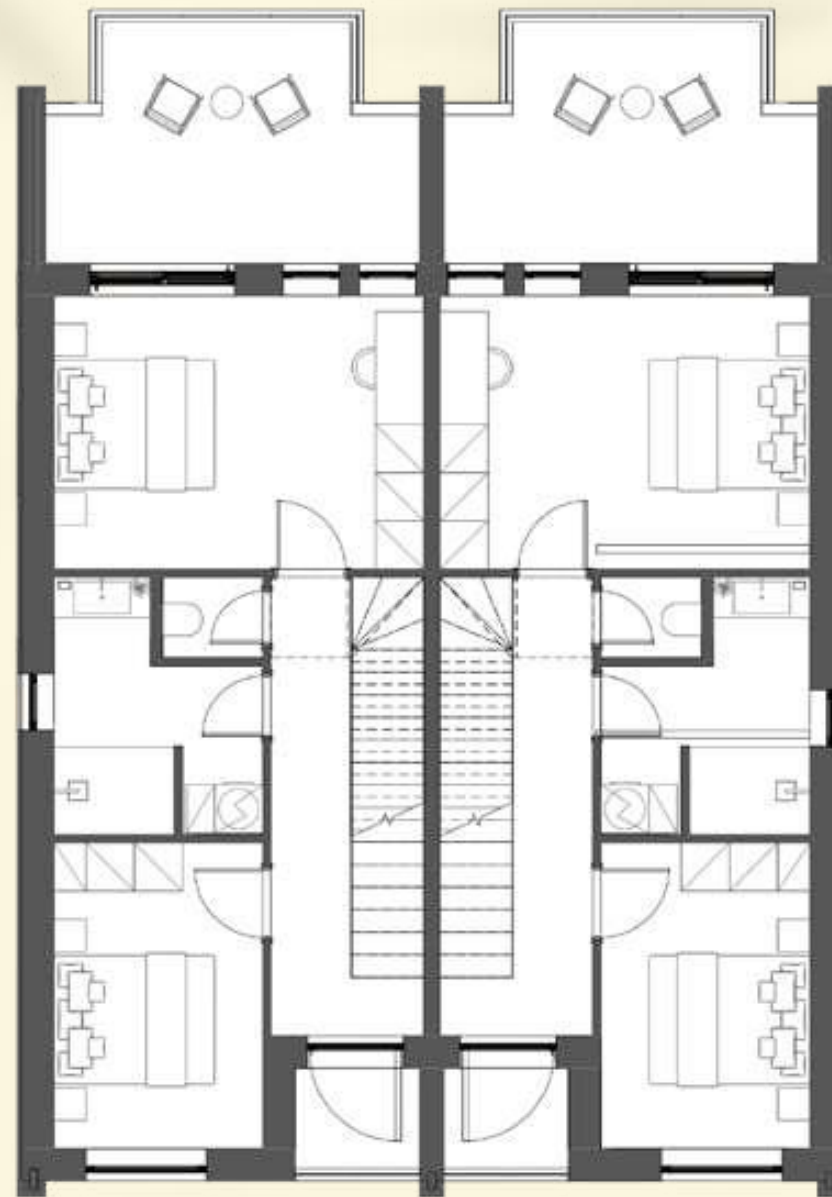

ATTIC

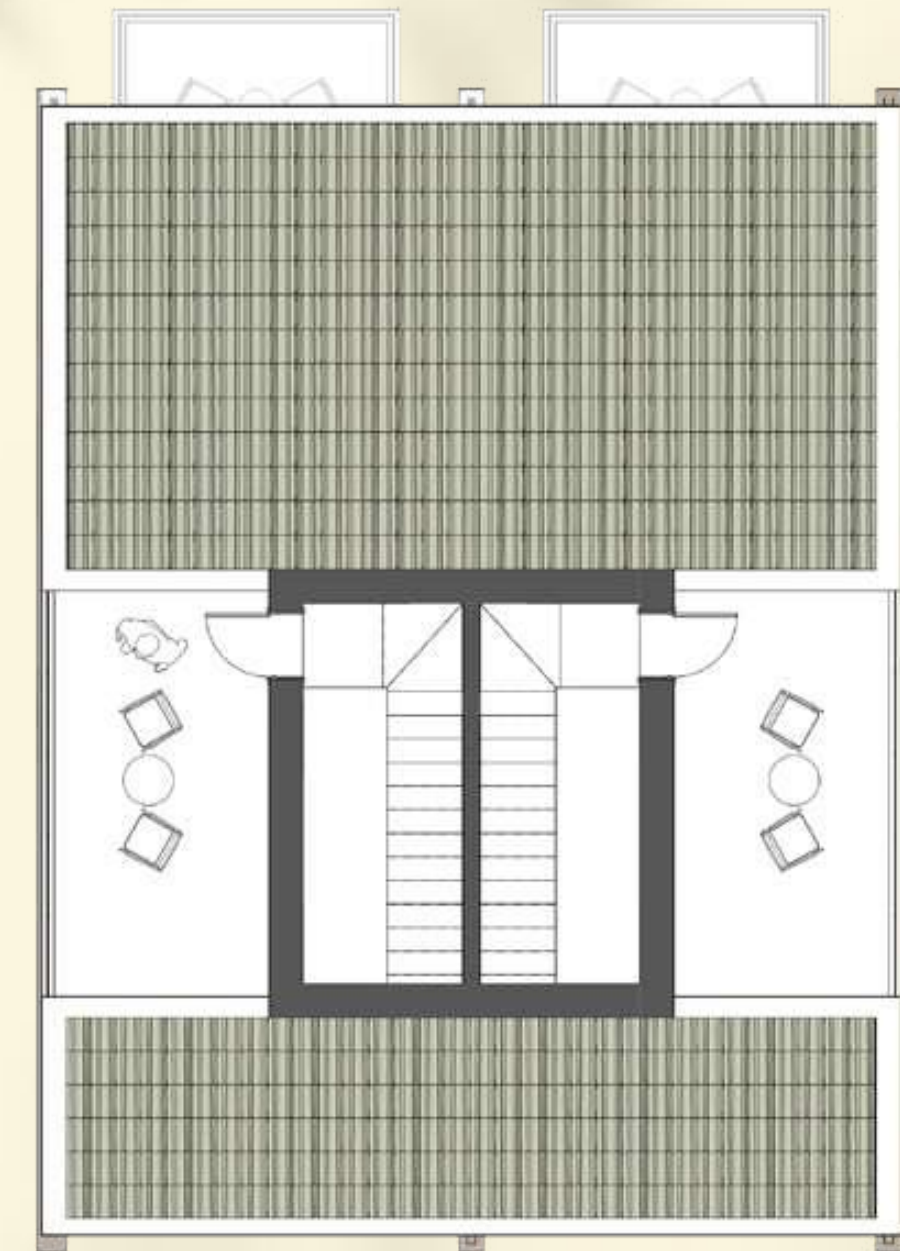

# VILLA YAIR



SR

# VILLA YAIR TYPICAL PLANS

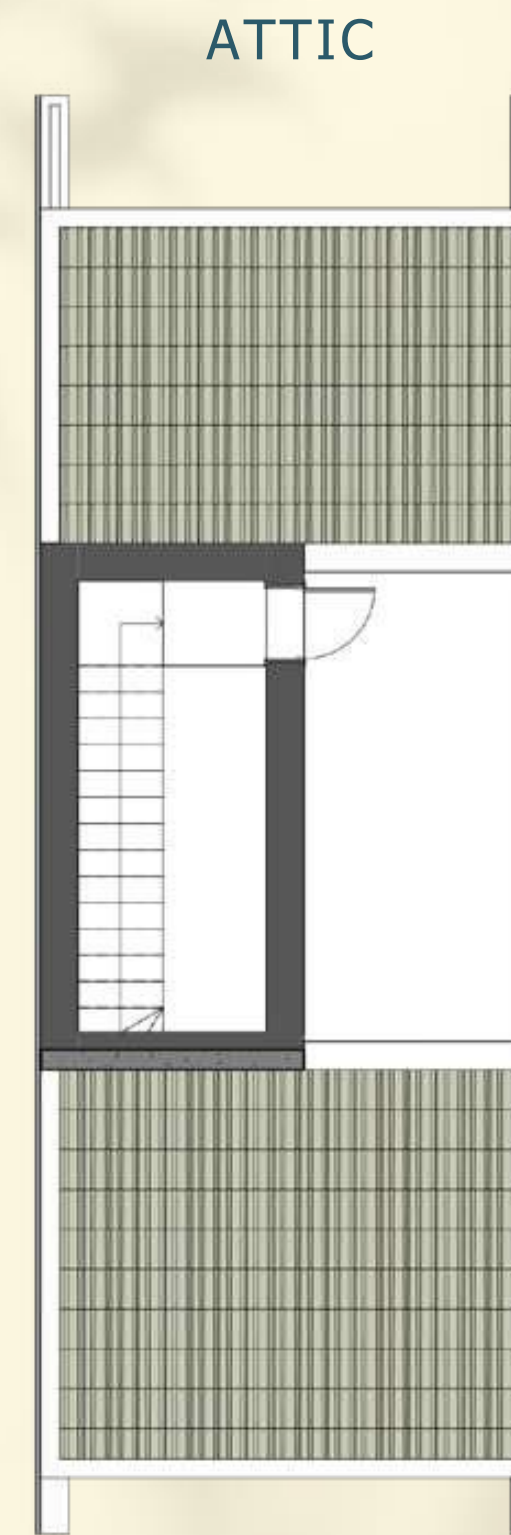
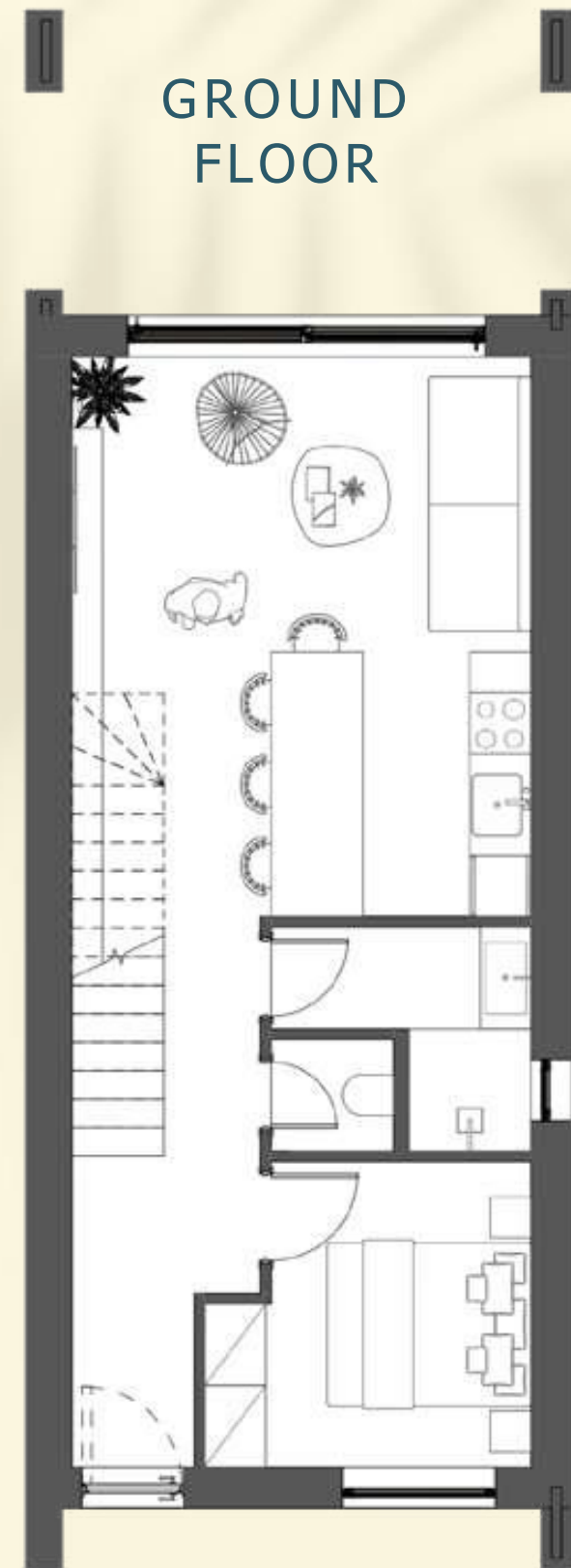

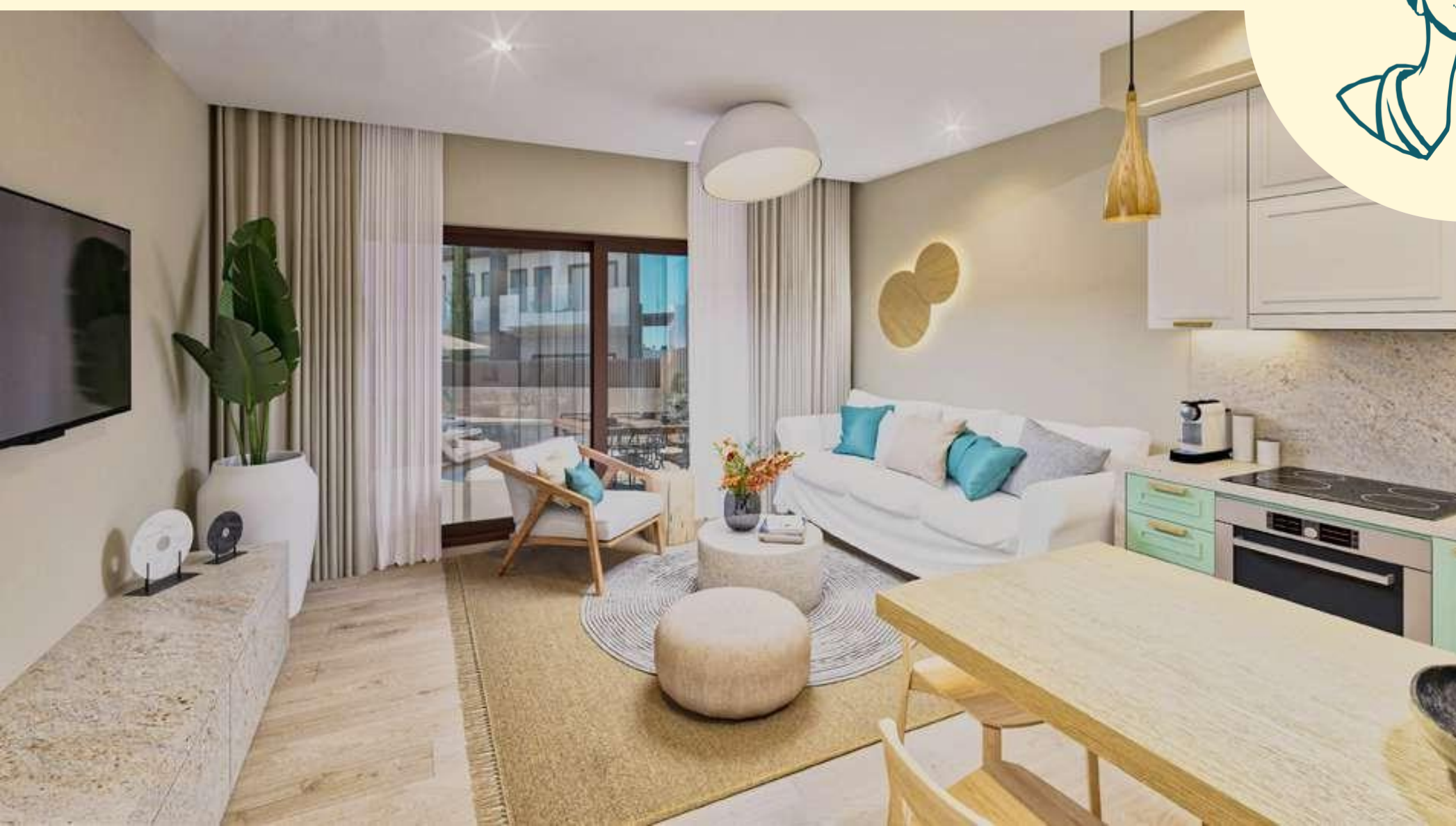

# VILLA GREEN TYPICAL PLANS

GROUND FLOOR  
APARTMENT



UPPER FLOOR  
APARTMENT



UPPER FLOOR APARTMENT ATTIC

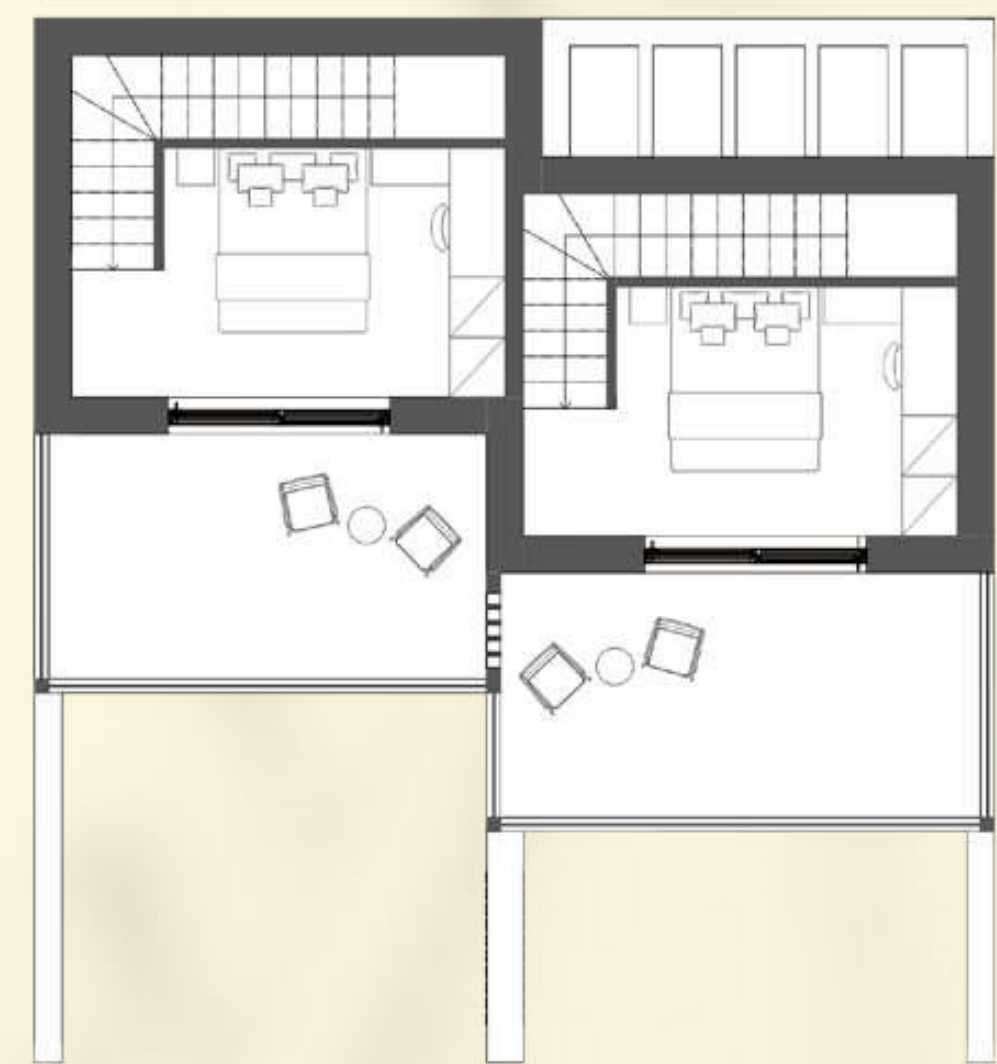

3D TOUR





## UPGRADES



### POOL

Minimum dimensions 2,50m x 4,00 m  
Pool heating system and pool cover products



### OUTDOOR JACUZZI

Relaxing hydrotherapy for multiple users



### 2-PERSON OUTDOOR

Traditional or infrared heating options



# UPGRADES



## BBQ

Outdoor BBQ corner with grill, counter, and sink



## SMART HOUSE

Enhance comfort, security and energy efficiency



## SECURITY

Building security alarm system  
Surveillance camera



## FIREPLACE

Indoor bioethanol fireplace installation



The Sea'cret  
Residences  
*Chiliadou*

## VILLAS CHILIADOU - PRICE LIST

### EXCLUSIVE PRE-SALE OPPORTUNITY

VILLA	UNITS	VILLA SIZE (M <sup>2</sup> )	PRE-SALE PRICE(€)	REGULAR PRICE(€)
LOLA	10	49-52	2950	3500
MIKKA	10	59-63	2950	3500
THAI	6	85	SOLD	SOLD
MICHAL	8	130-134	2950	3500
YAIR	3	142-150	2950	3500
YHONATAN	2	212-214	2950	3500

**TOTAL UNITS: 39**

**UPGRADE OPTIONS: SWIMMING POOL, SAUNA, FIREPLACE, FURNITURE, BBQ AREA**



The Sea'cret  
Residences  
*Chiliadou*

**VILLAS BY TYPE: YEHONATAN**

LOCATION	PLOT SIZE/M <sup>2</sup>	OUTDOOR AREA/M <sup>2</sup>	BEDROOMS	BATHROOMS	TOTAL AREA/M <sup>2</sup>	GROUND FLOOR/M <sup>2</sup>	UPPER FLOOR/M <sup>2</sup>	ATTIC	BALCONY /M <sup>2</sup>	ROOF TERRACE	PARKING
PLOT A	PLOT I 285.92	196.80	5	3	213.02	89.12	92.81	30.09	27.75	8.11	YES
PLOT A	PLOT II 251.23	141.23	5	3	213.28	90.00	93.19	30.09	24.78	8.11	YES

**TOTAL UNITS: 2**

**UPGRADE OPTIONS: SWIMMING POOL, SAUNA, FIREPLACE, FURNITURE, BBQ AREA**



The Sea'cret  
Residences  
*Chiliadou*

**VILLAS BY TYPE: YAIR**

LOCATION	PLOT SIZE/M <sup>2</sup>	OUTDOOR AREA/M <sup>2</sup>	BEDROOMS	BATHROOMS	TOTAL AREA/M <sup>2</sup>	GROUND FLOOR/M <sup>2</sup>	UPPER FLOOR/M <sup>2</sup>	ATTIC	BALCONY /M <sup>2</sup>	ROOF TERRACE	PARKING
PLOT B	PLOT I 185.50	124.42	3	2	141.26	59.08	66.22	15.96	10.42	10.75	YES
PLOT B	PLOT III 159.32	80.23	3	2	141.27	59.09	66.22	15.96	10.42	10.75	YES
PLOT B	PLOT III 168.16	104.98	3	2	150.08	63.18	70.94	15.96	10.57	12.50	YES

**TOTAL UNITS: 3**

**UPGRADE OPTIONS: SWIMMING POOL, SAUNA, FIREPLACE, FURNITURE, BBQ AREA**



The Sea'cret  
Residences  
*Chiliadou*

**VILLAS BY TYPE: TAI**

LOCATION	PLOT SIZE/M <sup>2</sup>	OUTDOOR AREA/M <sup>2</sup>	BEDROOMS	BATHROOMS	TOTAL AREA/M <sup>2</sup>	GROUND FLOOR/M <sup>2</sup>	UPPER FLOOR/M <sup>2</sup>	ATTIC	BALCONY /M <sup>2</sup>	ROOF TERRACE	PARKING
PLOT A	PLOT III 122.25	70.16	2	2	84.47	52.07	32.40	NO	22.43	NO	YES
PLOT A	PLOT IV 146.47	94.40	2	2	84.47	52.07	32.40	NO	22.43	NO	YES
PLOT B	PLOT IV 158.67	86.60	2	2	84.47	52.07	32.40	NO	22.43	NO	YES
PLOT B	PLOT V 145.70	91.63	2	2	84.47	52.07	32.40	NO	22.43	NO	YES
PLOT C	PLOT IV 158.86	106.79	2	2	84.47	52.07	32.40	NO	22.31	NO	YES
PLOT C	PLOT V 158.54	106.47	2	2	84.47	52.07	32.40	NO	22.31	NO	YES

**TOTAL UNITS: 6**

**UPGRADE OPTIONS: SWIMMING POOL, SAUNA, FIREPLACE, FURNITURE, BBQ AREA**



# The Sea'cret Residences

*Chiliadou*

## VILLAS BY TYPE: MIKA

LOCATION	PLOT LOCATION	BEDROOMS	BATHROOMS	TOTAL AREA/M <sup>2</sup>	FLOOR /M <sup>2</sup>	ATTIC	BALCONY /M <sup>2</sup>	ROOF TERRACE	PARKING
PLOT E	PLOT I	1	1	62.26	38.41	23.85	18.26	7.55	YES
PLOT E	PLOT II	1	1	62.26	38.41	23.85	11.49	10.60	YES
PLOT E	PLOT III	1	1	61.94	38.54	23.40	10.90	12.63	YES
PLOT E	PLOT IV	1	1	59.21	36.71	22.50	10.45	12.00	YES
PLOT E	PLOT V	1	1	62.84	38.99	23.85	17.92	7.55	YES
PLOT F	PLOT I	1	1	61.94	38.54	23.40	10.90	12.63	YES
PLOT F	PLOT II	1	1	59.21	36.71	22.50	10.45	12.00	YES
PLOT F	PLOT III	1	1	62.84	38.99	23.85	17.92	7.55	YES
PLOT F	PLOT IV	1	1	62.26	38.41	23.85	18.26	7.55	YES
PLOT F	PLOT V	1	1	62.26	38.41	23.85	11.49	10.60	YES

**TOTAL UNITS: 10**

**UPGRADE OPTIONS: JACUZZI, SAUNA, FIREPLACE, FURNITURE, BBQ AREA**



The Sea'cret  
Residences  
*Chiliadou*

**VILLAS BY TYPE: MICHAL**

LOCATION	PLOT SIZE/M <sup>2</sup>	OUTDOOR AREA/M <sup>2</sup>	BEDROOMS	BATHROOMS	TOTAL AREA/M <sup>2</sup>	GROUND FLOOR/M <sup>2</sup>	UPPER FLOOR/M <sup>2</sup>	ATTIC	BALCONY /M <sup>2</sup>	ROOF TERRACE	PARKING
PLOT C	PLOT I 205.97	145.92	3	<b>SOLD</b>	129.51	60.05	60.51	16.67	15.33	16.34	YES
PLOT C	PLOT II 136.81	79.96	3	2	129.51	56.85	57.31	15.35	14.86	14.78	YES
PLOT C	PLOT III 157.59	77.54	3	2	138.40	60.05	60.53	17.82	14.86	16.47	YES
PLOT D	PLOT I 217.03	154.71	3	2	133.29	56.61	56.61	14.36	14.89	13.01	YES
PLOT D	PLOT II 115.38	56.77	3	2	120.52	58.61	53.99	7.92	14.65	14.94	YES
PLOT D	PLOT III 144.51	81.70	3	2	133.25	62.81	57.16	13.28	15.19	13.01	YES
PLOT D	PLOT IV 153.00	70.69	3	2	131.78	62.31	56.70	12.77	15.53	13.01	YES
PLOT D	PLOT V 160.05	97.74	3	2	131.78	62.31	56.70	12.77	15.53	13.01	YES

**TOTAL UNITS: 8**

**UPGRADE OPTIONS: SWIMMING POOL, SAUNA, FIREPLACE, FURNITURE, BBQ AREA**



# The Sea'cret Residences

*Chiliadou*

## VILLAS BY TYPE: LOLA

LOCATION	PLOT SIZE/M <sup>2</sup>	OUTDOOR AREA/M <sup>2</sup>	BEDROOMS	BATHROOMS	TOTAL AREA/M <sup>2</sup>	GROUND FLOOR/M <sup>2</sup>	PARKING
PLOT E	PLOT I 112.19	60.71	1	1	51.48	51.48	YES
PLOT E	PLOT II 100.60	49.12	1	1	51.48	51.48	YES
PLOT E	PLOT III 99.91	48.45	SOLD	1	51.48	51.48	YES
PLOT E	PLOT IV 78.85	30.34	1	1	48.51	48.51	YES
PLOT E	PLOT V 81.70	30.28	1	1	51.48	51.48	YES
PLOT F	PLOT I 162.11	110.63	SOLD	1	51.48	51.48	YES
PLOT F	PLOT II 95.81	45.30	1	1	48.51	48.51	YES
PLOT F	PLOT III 122.08	70.60	1	1	51.48	51.48	YES
PLOT F	PLOT IV 89.79	38.31	1	1	51.48	51.48	YES
PLOT F	PLOT V 87.84	36.36	1	1	51.48	51.48	YES

**TOTAL UNITS: 10**

**UPGRADE OPTIONS: SWIMMING POOL, SAUNA, FIREPLACE, FURNITURE, BBQ AREA**

Join The Sea'cret

